

26TH ANNUAL
**MAKIN' THE GRADE
BULL SALE**



NOVEMBER 30th, 2022
DLMS FARMGATE TIMED AUCTIONS





BENCHMARK[®]

Your Carcass Source *Angus*

Friends and Fellow Cattlemen,

Welcome to our 26th Annual “Makin” the Grade Benchmark Bull Sale. The bulls really look the part with added thickness and depth of body. As in the past, we provide you with lots of information so you can not only visually appraise the bulls, but you have a real good indication of what traits the calves will carry from the bulls.

We focus on the visual aspects of the bulls as well as the phenotypic aspect, but we need more. We want to be using and producing seedstock that represent genetics in the “Top Percentiles” of the breed. One can select for the attributes one wants to emphasize, that being weaning weight, yearling weight, calving ease, marbling, ribeye, milk or whatever you feel will result in your being more profitable.

All the information provided is produced by the Canadian Angus Association and GrowSafe, with the Ultrasound data collected by Rod Wendorff and processed by CUP Labs. We find the resulting information very valuable. With the high cost of feed and inputs, it is absolutely necessary to realize extra dollars upon the sale of your calves and to do everything possible to reduce those feed costs by having efficient productive cattle.

As you know, our operation and our buy-back partners have put an emphasis on marbling, as it is the “meat shop,” that pays the bills. We have had loads of cattle grade as high as 88% PRIME with only 1 YG4 and no YG5’S.

We ask that you visit the ranch, take your time at evaluating the bulls. Anyone of our crew will be more than happy to show you around and answer your questions.

The guys at the ranch are the best. Dale and Laura are “empty nesters” and now grand parents. Mike and Hailey are the proud parents of a new baby boy and Lane has just become a property owner in Warner. Each one is an integral part of it all and we could not begin to do what we do without them.

In conclusion, let me say, Mike and I love this cattle and beef business and appreciate those who are a part of the Benchmark program. The journey has been very rewarding in so many ways. Do let us know if we can be of help in any way.

Sincerely from the Benchmark[®] team,

Doug Munton 403-328-6966

Michael Munton 403-394-4903

Dale Fehr 403-359-3274

Mike Trainer 403-890-6684

Lane Doud 403-308-4131



Benchmark

Angus



26TH ANNUAL MAKIN' THE GRADE BULL SALE



The Munton Family



Dale and Laura Fehr



Mike, Daicya, Lincoln and Lexington

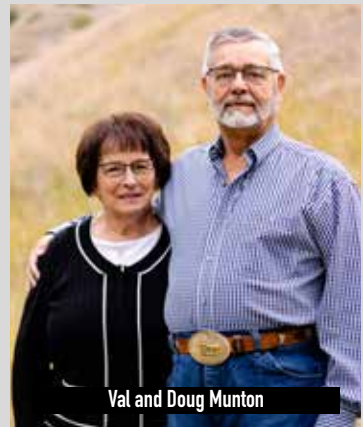

Val and Doug Munton



Lincoln and Lexington



Lane Doud



Mike and Hailey Trainer

OUR RANCH - OUR LEGACY

Enan Isaac Munton

Born January 2, 1879

Mary Anne Munton

Born August 18, 1886

Enan joined the army under-age serving in the 134th Battery Royal Horse & Field Artillery. Enan was a very good cricket player. After serving in the army he worked in the coal mines in Wales. They immigrated to Canada in 1912 with Enan working in the mines and then for the city of Lethbridge in Galt Gardens as a gardener.

In about 1915 Enan was granted a homestead East of Champion and they built a shack and moved. Those were very hard times, mining coal all winter and breaking the land and building fences to retain the few cattle they were able to buy with their "coal money". This homestead was the home of Stanley Munton. While on this homestead, Stanley, Doug and Ken developed East Champion Angus Ranch.



Stanley Warren Munton

Born May 16, 1927

Hilda Hilz

Born June 12, 1924

Stanley married Hilda Hilz on October 18, 1946. Hilda's parents gave them two cows as a wedding present which started them in the cattle business. Doug was born to Stan and Hilda July 29, 1947 and Ken on January 27, 1949. After working for a neighbor for the summer of 1960, Doug took his \$300 of earnings and with \$10 from his dad bought a Purebred Angus heifer from Alex Sera of Coalbridge Farms. This was the beginning of the Munton's endeavour into the Purebred Angus business, which continues to this day. Over the years the Munton's had great success breeding the likes of Ben's Big Boy 3'73 and Baros of Alcan Angus 40'73. Stan and Ken dispersed their cattle in 1989. Doug continued raising Angus cattle under the herd name Alcan Angus and now with his son Michael under the herd name Benchmark Angus.

Sadly, we lost Dad (Stan) in July of 2010 and Mother (Hilda) in March of 2020.





ONLINE SALE BY DLMS FARM GATE TIMED AUCTIONS

ON OFFER

43 coming Two-Year-Old Black Angus Bulls
21 coming Two-Year-Old Red Angus Bulls

Sale Day Phones

Doug Munton (403) 328-6966
Mike Munton (403) 394-4903
Mark Shologan (780) 699-5082

Cattle available at the ranch for viewing
November 16 through to sale day.

Semen Interest Retained Benchmark®
Angus retains a one-third semen interest
in every bull selling.



POST SALE

Free feed until December 31, 2022.
Feed at \$3 per day after year end.
Bulls left at the Ranch MUST be insured

STAY CONNECTED

Doug and Mike Munton
Box 997, Lethbridge, AB T1J 4A2
Phone: (403) 328-6966
Cell: (403) 394-4903
Email: doug@muntonco.com
See Catalogue online at
www.benchmarkangus.com

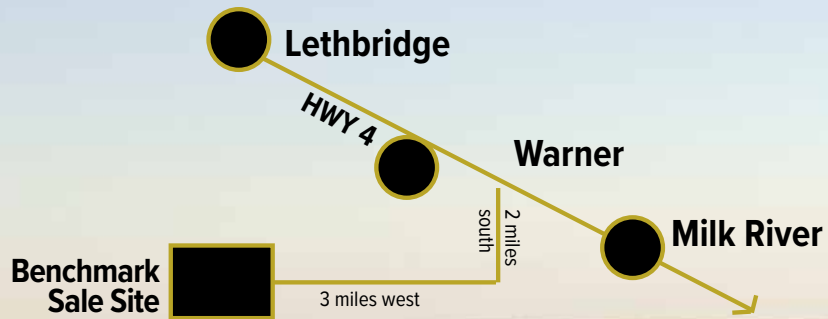

LOCATION:

Preview cattle November 16 - 30,
at Warner, go west down
Main Street, past the school and at
T intersection, turn left and go two
miles south, then right and go
three miles west.

HOW THE SALE WORKS!

RACEHORSE STYLE SALE WITH EXTENDED BIDDING.

First 30 min of Extended Bidding clock adds - 5 Minutes to close
Second 30 min of Extended Bidding clock adds - 3 Minutes to close
After an Hour of Extended Bidding clock adds - 1 Minute to close



1. Visit <https://farmgatetimedauctions.ca>, click the LOGIN/REGISTRATION button. First time users will select the REGISTER button from this page. Fill out the registration form to sign up for a free user account and it allows you to select a username and password for use on all Farm Gate Timed auctions. This program will send you text and email messages whenever there is activity on your favorite lots or someone challenges your proxy bid and this is why you will be asked for both your current email and cell phone number. If you are a past participant in the Farm Gate Timed auctions simply enter your user name and pass word to continue. This takes you to a list of both current and upcoming Farm Gate Auctions.
 2. You can choose your favourite lots in this sale at this time and the program will allow you to open either all sale lots or just your favorite lots on your screen. Any time there is active bidding on a lot you have identified on your favorite list you will get a text and/or an email noting this activity.
 3. The program allows you to place a proxy bid on any sale lot. This in fact protects your interest in any lot of interest for you to a specified dollar value you set, when you may not be able to give 100% attention to the sale. If the lot has a \$2000 bid on it and you place a proxy bid of \$3500 into the system, the computer will bid \$2100 for you but if some one else bids \$2200, the computer will again bid for you, this time at \$2300. The system will look after your interest to a maximum of \$3500. If another bidder is on at \$3600, your proxy will no longer be effective and you will no longer have the winning bid on this lot without once again logging in and bidding again or moving your attention to a second lot of interest.
 4. At Closing time of the sale the entire sale will extend bidding for 5 minute if a bid is placed on any lot in the sale. Any bid received after 7 PM will extend the sale by 5 minutes from the time of that bid. When no bidding occurs for 5 min the computer will declare the sale finished.
 5. Within 24 hours of the sale close the Sale consignor will contact all winning bidders to arrange payment, transfer of pedigrees and delivery/Pick up of your lot.
- If you require assistance with using the new DLMS Farm Gate web site, if you don't understand how to create a favorites list, if you can't figure out the proxy bid or you just plain want to bid via phone, please talk to any of the DLMS team or Sale Consignors.

More Info:

What is Racehorse Style Close?

Racehorse style sale close is when the entire sale stays open in extended bidding. This type of sale allows you as the bidder to change to a different lot within the same sale if the bidding has gone into extended bidding.

How will Extended Bidding works?

When we get to the close out end time the clock for close extends with any bid placed with less than 5 min on the clock. This type of extended bidding turns the end time to more of a soft time. Extended bidding allows bidders to compete in lots like a real auction and give all bidders the same time to make a decision. Always follow the clock to see how much time remains in the sale you are interested in.



Benchmark Angus ventured into the beef business out of necessity in 2003. BSE had hit the cattle business and we had no market for the cattle we had proudly produced for generations. Mike started harvesting those cattle that we could not sell otherwise & marketing it to local restaurants & grocery stores.

Through many ups & downs things progressed and we developed a wonderful customer base that are very passionate about our very high quality beef product. In 2015, the opportunity came along to purchase a harvest facility in the heart of cattle feeding country; Picture Butte, AB. On January 1, 2016, we took over the day to day operations of Ben's Quality Meats and we have seen an explosion of the demand in Benchmark Premium Angus Beef.

Today when looking at a ranking for marbling on the 2021 born Black Angus Bulls, listed by the Canadian Angus Association, the very top ranked Canadian born bull for marbling sells as Lot 13 in this sale. On the Red side, the top 3 ranked 2021 born Red Angus bulls are all from Benchmark® with the very top marbling bull selling as Lot 64. The pursuit matters; our customers receive the benefit when they are paid well above the market for their Benchmark sired calves. But the beef customer is the real winner when they tell us time after time they never thought beef could taste so good.

Why do we talk about this so much? Because, it matters so much and as we harvest more and more animals, we know we have been on the right track. Dr. Miller has said "At the end of the day, all the best science is for naught if it does not show up in an improvement in cattle on the ranch, in the feedlot and the beef on the consumer's plate."

As we process "Benchmark Beef", as well as commodity beef, the differences clearly come to light. And even in our earlier days, prior to having the predictability in our cattle, some made the grade and others did not. Now, the genetics in an animal tells the tale before the grading stamp goes on.

Our goal is to provide the genetics to our valued customers allowing them to be the most profitable in the business. We need more Benchmark sired cattle to meet the demand. If you are using Benchmark Bulls, we would like to visit about access to their calves and if not using Benchmark Bulls we ask that you consider using them. Be sure your cattle measure up – use a Benchmark Bull!"

Remember, "Pasture to Plate", it is not just an old cliché at Benchmark, we do it every day!

Doug Munton: (403)-328-6966

Michael Munton (403)-394-4903



REFERENCE SIRE

BENCHMARK ASHLAND 229'18



CAA
GENOMIC
ENHANCED
EPDs

CE
+8.0

BW
+2.4

WW
+83

YW
+139

CW
+48

MARB
+1.21

REA
+0.76

DOC
+21

CBI
+250

PERF	AOD	BW	205D	365D
	2	80	738	1072

G A R DAYLIGHT
G A R EARLY BIRD
G A R PROGRESS 830
G A R ASHLAND 2133793
B/R AMBUSH 28
CHAIR ROCK AMBUSH 1018
G A R YIELD GRADE N366
SIRE: BENCHMARK ASHLAND 229'18 (2145957)
MCC DAYBREAK
G A R ANTICIPATION
G A R 5050 NEW DESIGN 0530
G A R ANTICIPATION N506 2030260
CONNEALY CONTRAST
G A R CONTRAST L234
G A R OBJECTIVE 0J06

Benchmark Ashland 229'18 came in dam from a bred heifer we purchased from Gardiner Angus Ranch. Being born September 29, 2018 he was not available for breeding until the 2020 breeding season. Ashland 229'18 sired 63 calves that year, 34 bull calves with an avg BW of 85 lbs and 29 heifer calves with an average BW of 74 lbs. On weaning the bull calves ratioed 102 and at yearling 102. The heifer calves ratioed 102 at weaning and 101 at yearling. A very productive first year. His calves come easy and gain and grade. They have extra thickness and depth of body.

20 SONS SELL

- Avg. BW: 84 lbs
- Avg. 205D: 664 lbs.
- Avg. 365D: 1275 lbs

SEPTEMBER 2022 EPD RANKING:

Top 1% Weaning Weight	Top 15% Calving Ease
Top 1% Yearling Weight	Top 15% Scrotal
Top 1% Marbling	Top 20% Carcass Weight
Top 8% Ribeye	

BULL SIRED BY BENCHMARK ASHLAND 229'18

LOT 1

BENCHMARK ASHLAND 41'21
Male BFL 41J April 22 2021

2217361



G A R ASHLAND
Sire: **BENCHMARK ASHLAND 229'18**
G A R ANTICIPATION N506
K C F BENNETT THEROCK
Dam: **BENCHMARK MISS COMPLETE 6'18**
BENCHMARK MISS COMPLETE 159'16

G A R EARLY BIRD
CHAIR ROCK AMBUSH 1018
G A R ANTICIPATION
G A R CONTRAST L234
K C F BENNETT SOUTHSIDE
K C F MISS PROTEGE
G A R BASELINE AB297
G A R COMPLETE 1381

CARCASS	
EPD'S:	
MARB	+1.46
REA	+0.53
CW	+50
FAT	+0.026
ACTUAL:	
%IMF	6.52
REA	0.99
RIB FAT	0.39
LMY	58.8%

PERFORMANCE						EPD's						
AOD	BW	205D	365D	ADG	F:G	RFI	CE	BW	WW	YW	RFI	CBI
3	81	655	1304	4.56	5.95:1	+1.04	+14.0	+0.5	+73	+130	+0.35	+271

SEPTEMBER 2022 EPD RANKING:

Top 1% Marbling
Top 1% Calving Ease
Top 1% Docility

Top 2% Weaning Weight
Top 2% Yearling Weight
Top 3% Mat Calving Ease

Top 15% Carcass Weight

From a real nice "The Rock" daughter who traces to 1381 the dam of Micah and Premium both used extensively in our herd, the Greg Nolan herd, and the Cee Jay herd.

LOT 2

BENCHMARK ASHLAND 54'21
Male BFL 54J April 26, 2021

2217367



G A R ASHLAND DDF
Sire: **BENCHMARK ASHLAND 229'18**
G A R ANTICIPATION N506
G A R BASELINE AB297 DDF
Dam: **BENCHMARK ISABELLA 205'17**
LCOC ISABELLA TG114

G A R EARLY BIRD
CHAIR ROCK AMBUSH 1018
G A R ANTICIPATION
G A R CONTRAST L234
G A R NEW DESIGN 5050
G A R OBJECTIVE 648S AMF
GARDENS PRIME STAR
LCOC ISABELLA RG748

CARCASS	
EPD'S:	
MARB	+0.85
REA	+0.92
CW	+44
FAT	+0.076
ACTUAL:	
%IMF	4.89
REA	1.15
RIB FAT	0.54
LMY	57.8%

PERFORMANCE						EPD's						
AOD	BW	205D	365D	ADG	F:G	RFI	CE	BW	WW	YW	RFI	CBI
4	80	614	1271	3.66	6.55:1	-0.71	+13.0	+0.6	+69	+120	+0.20	+258

SEPTEMBER 2022 EPD RANKING:

Top 2% Calving Ease
Top 2% Ribeye

Top 5% Weaning Weight
Top 6% Yearling Weight

Top 7% Marbling
Top 15% Mat Calving Ease

This dam traces to a female we purchased from Lee Leachman in Colorado.



THE BEST TASTING BEEF FOR NEARLY 100 YEARS.

Currently, our fourth generation in ranching continues the ongoing quest for the productive and efficient cattle that are continually exceeding the industry standards and satisfying all who consume beef. The Munton family has been pursuing Angus beef genetics for the proven tenderness and far superior taste that only Premium Benchmark Angus Cattle provide.



403-732-5122
BENQMEATS.NET
BENQMEATS@GMAIL.COM
100 FACTORY DRIVE
BOX 129
PICTURE BUTTE, AB T0K 1V0



BULL SIRED BY BENCHMARK ASHLAND 229'18

LOT 3

BENCHMARK ASHLAND 73'21

Male BFL 73J May 3, 2021

2217399



G A R ASHLAND
 Sire: **BENCHMARK ASHLAND 229'18**
 G A R ANTICIPATION N506
 WR JOURNEY-1X74
 Dam: **BENCHMARK TIBBIE D 15'17 (1957874)**
 BENCHMARK TIBBIE D 128'15 DDF
 BENCHMARK TIBBIE D 18'12

G A R EARLY BIRD
 CHAIR ROCK AMBUSH 1018
 G A R ANTICIPATION
 G A R CONTRAST L234
 B/R FUTURE DIRECTION 4268
 2 BAR 5050 NEW DESIGN 7831
 G A R END POINT 5122
 BENCHMARK TIBBIE D 18'12

CARCASS	
EPD's:	
MARB	+1.05
REA	+1.08
CW	+26
FAT	-0.021
ACTUAL:	
%IMF	5.49
REA	1.27
RIB FAT	0.39
LMY	63.2%

PERFORMANCE							EPD's					
AOD	BW	205D	365D	ADG	F:G	RFI	CE	BW	WW	YW	RFI	CBI
4	84	690	1310	3.24	7.38:1	-0.04	+12	+0.2	+68	+115	+0.16	+253

SEPTEMBER 2022 EPD RANKING:		
Top 1% Ribeye	Top 4% Fat	Top 9% Yearling Weight
Top 3% Marbling	Top 6% Weaning Weight	
Top 4% Calving Ease	Top 6% Mat Calving Ease	

Marbling and Ribeye both over +1.00 with minus for fat. His calves will gain and grade.

LOT 4

BENCHMARK ASHLAND 84'21

Male BFL 84J May 7, 2021

2217351



G A R ASHLAND
 Sire: **BENCHMARK ASHLAND 229'18**
 G A R ANTICIPATION N506
 BENCHMARK PREMIUM 2'15
 Dam: **BENCHMARK ESTER 72'18 (2029730)**
 BENCHMARK ESTER 13'16

G A R EARLY BIRD
 CHAIR ROCK AMBUSH 1018
 G A R ANTICIPATION
 G A R CONTRAST L234
 G A R PROPHET A011
 G A R COMPLETE 1381
 G A R BASELINE AB297
 BENCHMARK ESTER 0135

CARCASS	
EPD's:	
MARB	+1.20
REA	+0.83
CW	+41
FAT	-0.008
ACTUAL:	
%IMF	5.03
REA	1.09
RIB FAT	0.38
LMY	61.4%

PERFORMANCE							EPD's					
AOD	BW	205D	365D	ADG	F:G	RFI	CE	BW	WW	YW	RFI	CBI
3	82	714	1416	4.19	6.51:1	+1.85	+10.0	+1.8	+73	+128	+0.31	+276

SEPTEMBER 2022 EPD RANKING:		
Top 1% Y Marbling	Top 4% Ribeye	Top 10% Fat
Top 2% Weaning Weight	Top 5% Milk	
Top 2% Yearling Weight	Top 9% Calving Ease	

This guy ratioed 112 at weaning and 125 at yearling. From a very moderate Premium daughter.



LOT 3

BULL SIRED BY BENCHMARK ASHLAND 229'18

LOT 5

BENCHMARK ASHLAND 90'21
Male BFL 90J May 7, 2021

2217396



G A R ASHLAND
Sire: **BENCHMARK ASHLAND 229'18**
G A R ANTICIPATION N506
G A R CONTRAST L234
G A R NEW DESIGN 5050
G A R BASELINE AB297 DDF
Dam: **BENCHMARK HEROINE 24'17 (1957882)**
G A R EFFICIENCY 7295
BENCHMARK HEROINE 8235
BENCHMARK HEROINE 619

CARCASS	
EPD'S:	
MARB	+0.81
REA	+0.74
CW	+40
FAT	+0.050
ACTUAL:	
%IMF	6.28
REA	1.12
RIB FAT	0.57
LMY	55.4%

PERFORMANCE							EPD's					
AOD	BW	205D	365D	ADG	F:G	RFI	CE	BW	WW	YW	RFI	CBI
4	77	650	1246	3.95	6.47:1	+0.35	+7.0	+0.2	+70	+121	+0.21	+277

SEPTEMBER 2022 EPD RANKING:

Top 4% Weaning Weight
Top 5% Yearling Weight
Top 8% Marbling
Top 8% Milk
Top 9% Ribeye
Top 15% Birth Weight

From a real nice Baseline daughter who has two daughters at Iron Horse Cattle Co.

LOT 6

BENCHMARK ASHLAND 99'21
Male BFL 99J May 11, 2021

2217327



G A R ASHLAND
Sire: **BENCHMARK ASHLAND 229'18**
G A R ANTICIPATION N506
G A R CONTRAST L234
V A R GENERATION 2100
EF PRIME QUARTER 5369
Dam: **BENCHMARK ESTER 139'18 (2029791)**
N BAR EMULATION EXt
BENCHMARK ESTER 862
THOMAS ESTER 0190

CARCASS	
EPD'S:	
MARB	+0.95
REA	+0.37
CW	+35
FAT	+0.025
ACTUAL:	
%IMF	4.73
REA	1.05
RIB FAT	0.40
LMY	58.3%

PERFORMANCE							EPD's					
AOD	BW	205D	365D	ADG	F:G	RFI	CE	BW	WW	YW	RFI	CBI
3	78	593	1223	3.95	6.26:1	+0.99	+8.0	+1.8	+62	+111	+0.35	+261

SEPTEMBER 2022 EPD RANKING:

Top 4% Marbling
Top 5% Milk
Top 10% Yearling Weight
Top 10% Mat Calving Ease
Top 15% Weaning Weight
Top 15% Calving Ease



LOT 5

COLLEGE Ford Lincoln
LETHBRIDGE
403.329.0333
3975 1 Ave South, Lethbridge
SALES · SERVICE · PARTS

YOUR TRUCK SUPERSTORE

BUILT Ford TOUGH

COLLEGE Ford TABER
403 223-9654
94402 46 Ave, Taber
Sales
Parts
Service

2020 Ford Ranger

BULL SIRED BY BENCHMARK ASHLAND 229'18

LOT 7 **BENCHMARK ASHLAND 100'21** 2217359
Male BFL 100J May 11, 2021

ANGUS

G A R ASHLAND G A R EARLY BIRD
CHAIR ROCK AMBUSH 1018
Sire: **BENCHMARK ASHLAND 229'18**
G A R ANTICIPATION
G A R ANTICIPATION N506 G A R CONTRAST L234
BALDRIDGE WAYLON W34
44 ARSENAL 4W07
DZ ND 5050 OF15
Dam: **BENCHMARK SALLY 10'18 (2017354)**
BENCHMARK MICAH 247'13
BENCHMARK SALLY 94'16
BENCHMARK SALLY 155'11

CARCASS	
EPD'S:	
MARB	+0.60
REA	+0.86
CW	+55
FAT	+0.00
ACTUAL:	
%IMF	5.06
REA	1.15
RIB FAT	0.34
LMY	61.9%

PERFORMANCE							EPD's					
AOD	BW	205D	365D	ADG	F:G	RFI	CE	BW	WW	YW	RFI	CBI
3	84	683	1317	4.06	5.33:1	-3.68	+5.0	+2.0	+73	+125	-0.35	+299

SEPTEMBER 2022 EPD RANKING:

Top 2% Weaning Weight	Top 9% Carcass Weight
Top 3% Yearling Weight	Top 20% Marbling
Top 3% Ribeye	Top 20% Fat

Weaning Weight Ratio of 107 and Yearling Weight Ratio of 113 on this guy!

LOT 8 **BENCHMARK ASHLAND 116'21** 2231985
Male BFL 116J May 17, 2021

ANGUS

G A R ASHLAND G A R EARLY BIRD
CHAIR ROCK AMBUSH 1018
Sire: **BENCHMARK ASHLAND 229'18**
G A R ANTICIPATION
G A R ANTICIPATION N506 G A R CONTRAST L234
SITZ UPWARD 307R
TRIARA MADE TO ORDER 366Y
RBF RITA 6A98 4TV7 2A63
Dam: **BENCHMARK SALLY 63'13 (1741618)**
STANDARD HILL PAYOFF 20P
BENCHMARK SALLY 8197
SUPERB 410H LASS

CARCASS	
EPD'S:	
MARB	+0.69
REA	+0.72
CW	+51
FAT	-0.016
ACTUAL:	
%IMF	2.79
REA	1.16
RIB FAT	0.24
LMY	64.2%

PERFORMANCE							EPD's					
AOD	BW	205D	365D	ADG	F:G	RFI	CE	BW	WW	YW	RFI	CBI
8	93	686	1270	5.07	5.17:1	-0.77	+4.0	+2.6	+69	+123	+0.25	+289

SEPTEMBER 2022 EPD RANKING:

Top 4% Yearling Weight	Top 10% Marbling
Top 5% Weaning Weight	Top 10% Ribeye

Maternal brother to the high-selling bull in sale XXIV

LOT 9 **BENCHMARK ASHLAND 118'21** 2217413
Male BFL 118J May 19, 2021

ANGUS

G A R ASHLAND G A R EARLY BIRD
CHAIR ROCK AMBUSH 1018
Sire: **BENCHMARK ASHLAND 229'18**
G A R ANTICIPATION
G A R ANTICIPATION N506 G A R CONTRAST L234
B/R DESTINATION 727-928
G A R END POINT 5122
A R 28 AMBUSH 1949
Dam: **BENCHMARK QUEEN 166'15 (1834905)**
BENCHMARK PREDESTINED 8301
BENCHMARK QUEEN 246'11
G A R RETAIL PRODUCT 2057

CARCASS	
EPD'S:	
MARB	+0.80
REA	+0.71
CW	+59
FAT	+0.046
ACTUAL:	
%IMF	3.98
REA	1.06
RIB FAT	0.31
LMY	61.9%

PERFORMANCE							EPD's					
AOD	BW	205D	365D	ADG	F:G	RFI	CE	BW	WW	YW	RFI	CBI
6	82	627	1337	3.90	6.5:1	-0.22	+5.0	+1.8	+69	+121	+0.35	+264

SEPTEMBER 2022 EPD RANKING:

Top5% Weaning Weight	Top 5% Carcass Weight	Top 10% Ribeye
Top 5% Yearling Weight	Top 10% Marbling	

The dam here has a daughter in the herd a son at Aarbo Ranching and a 4-H project heifer for Alyssa Groves.

GIVE AWAY

WESTERN STOCKMAN GIFT CARD

\$500

FOR THE VOLUME BUYER

BULL SIRED BY BENCHMARK ASHLAND 229'18

LOT 10

BENCHMARK ASHLAND 122'21

2219106

Male LAA 122J May 19, 2021



G A R ASHLAND	G A R EARLY BIRD	<table border="1"> <tr><td>CARCASS</td><td></td></tr> <tr><td>EPD'S:</td><td></td></tr> <tr><td>MARB</td><td>+0.84</td></tr> <tr><td>REA</td><td>+0.47</td></tr> <tr><td>CW</td><td>+41</td></tr> <tr><td>FAT</td><td>+0.040</td></tr> <tr><td>ACTUAL:</td><td></td></tr> <tr><td>%IMF</td><td>4.70</td></tr> <tr><td>REA</td><td>1.04</td></tr> <tr><td>RIB FAT</td><td>0.50</td></tr> <tr><td>LMY</td><td>56.1%</td></tr> </table>	CARCASS		EPD'S:		MARB	+0.84	REA	+0.47	CW	+41	FAT	+0.040	ACTUAL:		%IMF	4.70	REA	1.04	RIB FAT	0.50	LMY	56.1%
CARCASS																								
EPD'S:																								
MARB	+0.84																							
REA	+0.47																							
CW	+41																							
FAT	+0.040																							
ACTUAL:																								
%IMF	4.70																							
REA	1.04																							
RIB FAT	0.50																							
LMY	56.1%																							
	CHAIR ROCK AMBUSH 1018																							
Sire: BENCHMARK ASHLAND 229'18	G A R ANTICIPATION																							
G A R ANTICIPATION N506	G A R CONTRAST L234																							
	G A R PREDESTINED																							
BENCHMARK PREDESTINED 8301	G A R T510 TRAVELER 264 AMF																							
Dam: BENCHMARK LAVENDER LADY 50'11 (1618156)	STANDARD HILL PAYOFF 20P																							
BENCHMARK LAVENDER LADY 918	BENCHMARK MICAH 247'13																							

PERFORMANCE						EPD's						
AOD	BW	205D	365D	ADG	F:G	RFI	CE	BW	WW	YW	RFI	CBI
10	83	652	1273	3.92	5.91:1	-1.96	+5.0	+2.6	+64	+113	+0.16	+207

SEPTEMBER 2022 EPD RANKING:		
Top 7% Marbling	Top 10% Weaning Weight	Top 10% Yearling Weight

LOT 11

BENCHMARK ASHLAND 125'21

2231993

Male BFL 125J May 20 2021



G A R ASHLAND	G A R EARLY BIRD	<table border="1"> <tr><td>CARCASS</td><td></td></tr> <tr><td>EPD'S:</td><td></td></tr> <tr><td>MARB</td><td>+0.85</td></tr> <tr><td>REA</td><td>+0.48</td></tr> <tr><td>CW</td><td>+35</td></tr> <tr><td>FAT</td><td>+0.021</td></tr> <tr><td>ACTUAL:</td><td></td></tr> <tr><td>%IMF</td><td>3.40</td></tr> <tr><td>REA</td><td>1.10</td></tr> <tr><td>RIB FAT</td><td>0.35</td></tr> <tr><td>LMY</td><td>60.5%</td></tr> </table>	CARCASS		EPD'S:		MARB	+0.85	REA	+0.48	CW	+35	FAT	+0.021	ACTUAL:		%IMF	3.40	REA	1.10	RIB FAT	0.35	LMY	60.5%
CARCASS																								
EPD'S:																								
MARB	+0.85																							
REA	+0.48																							
CW	+35																							
FAT	+0.021																							
ACTUAL:																								
%IMF	3.40																							
REA	1.10																							
RIB FAT	0.35																							
LMY	60.5%																							
	CHAIR ROCK AMBUSH 1018																							
Sire: BENCHMARK ASHLAND 229'18	G A R ANTICIPATION																							
G A R ANTICIPATION N506	G A R CONTRAST L234																							
	C R A BEXTOR 872 5205 608																							
	TC ABERDEEN 759																							
Dam: BENCHMARK QUEEN 221'11 (1654393)	BLACKBIRD 403																							
	S S TRAVELER 6807 T510																							
G A R T510 TRAVELER 264	G A R EXPECTATION 1151																							

PERFORMANCE						EPD's						
AOD	BW	205D	365D	ADG	F:G	RFI	CE	BW	WW	YW	RFI	CBI
10	89	644	1254	3.92	6.21:1	-0.82	+8.0	+1.2	+63	+111	+0.27	+257

SEPTEMBER 2022 EPD RANKING:		
Top 7% Marbling	Top 10% Weaning Weight	Top 10% Yearling Weight
Top 15% Calving ease		

The dam of Lot 10 has stood the test of time with sons at Rosetown, Blood Band Ranch, Forty Mile Grazing, and Aarbo Ranching with a daughter working at Benchmark*.

Maternal brothers serve at Rosetown and for Robert Johnston with a daughter retained.



LOT 10

BULL SIRED BY BENCHMARK ASHLAND 229'18

LOT 12

BENCHMARK ASHLAND 127'21

2219104

Male LAA 127J May 22 2021



G A R ASHLAND
CHAIR ROCK AMBUSH 1018
Sire: BENCHMARK ASHLAND 229'18
G A R ANTICIPATION N506
G A R CONTRAST L234
D H D TRAVELER 6807
RITO 419 OF 2536 6807
G A R PRECISION 253
Dam: BENCHMARK BLACKBIRD 32'11 (1618154)
BASIN PRIME CUT 080M
BENCHMARK BLACKBIRD 6196
THOMAS BLACKBIRD 9537

CARCASS	
EPD's:	
MARB	+0.76
REA	+0.87
CW	+47
FAT	-0.027
ACTUAL:	
%IMF	3.30
REA	1.24
RIB FAT	0.28
LMY	62.9%

PERFORMANCE						EPD's						
AOD	BW	205D	365D	ADG	F:G	RFI	CE	BW	WW	YW	RFI	CBI
10	80	690	1200	5.05	4.84:1	-1.32	+10.0	+0.2	+71	+120	+0.01	+266

SEPTEMBER 2022 EPD RANKING:

Top 2% Fat	Top 3% Ribeye	Top 9% Calving Ease
Top 3% Weaning Weight	Top 6% Yearling Weight	Top 10% Marbling

Dam here has had sons serve for East Raymond and Rod Nelson Farms with three daughters retained.

LOT 13

BENCHMARK ASHLAND 130'21

2231983

Male BFL 130J May 22 2021



G A R ASHLAND
CHAIR ROCK AMBUSH 1018
Sire: BENCHMARK ASHLAND 229'18
G A R ANTICIPATION N506
G A R CONTRAST L234
G A R PROPHET
G A R PROPHET A011
G A R 1407 NEW DESIGN 306
Dam: BENCHMARK BLACKCAP 158'13 (1741690)
G A R EFFICIENCY 7295
BENCHMARK BLACKCAP 177'11
BENCHMARK BLACKCAP 683

CARCASS	
EPD's:	
MARB	+1.69
REA	+0.35
CW	+22
FAT	+0.037
ACTUAL:	
%IMF	6.93
REA	1.2
RIB FAT	0.41
LMY	58.5%

PERFORMANCE						EPD's						
AOD	BW	205D	365D	ADG	F:G	RFI	CE	BW	WW	YW	RFI	CBI
8	99	613	1223	3.77	6.35:1	+0.37	+10.0	+1.0	+61	+105	+0.59	+267

SEPTEMBER 2022 EPD RANKING:

Top 1% Marbling	Top 15% Weaning Weight
Top 9% Calving Ease	Top 20% Yearling Weight

Checkout this guys actual % IMF score and his Marbling EPD. His calves will grade!



LOT 12

BULL SIRED BY BENCHMARK ASHLAND 229'18

LOT 14 **BENCHMARK ASHLAND 132'21**
Male BFL 132J May 22 2021

2217408



G A R ASHLAND
Sire: **BENCHMARK ASHLAND 229'18**
G A R ANTICIPATION N506
G A R ANTICIPATION N506
G A R BASELINE AB297
Dam: **BENCHMARK ELBINA 28'16 (1899307)**
BENCHMARK ELBINA 839

G A R EARLY BIRD
CHAIR ROCK AMBUSH 1018
G A R ANTICIPATION
G A R CONTRAST L234
G A R NEW DESIGN 5050
G A R OBJECTIVE 648S
SITZ TRAVELER 043
ROYAL ELBINA DRCC 2043M

CARCASS	
EPD'S:	
MARB	+0.90
REA	+0.42
CW	+12
FAT	-0.014
ACTUAL:	
%IMF	3.51
REA	1.16
RIB FAT	0.27
LMY	62.3%

PERFORMANCE							EPD's					
AOD	BW	205D	365D	ADG	F:G	RFI	CE	BW	WW	YW	RFI	CBI
5	77	627	1153	3.33	6.75:1	0.00	+15.0	-1.4	+44	+82	+0.14	+220

SEPTEMBER 2022 EPD RANKING:

Top 1% Calving Ease
Top 3% Birth Weight
Top 6% Marbling
Top 8% Fat

A Prime Quarter daughter of Elbina 28'16 works for Rob Reynolds. Heifer bull for sure with Lot 14.

LOT 15 **BENCHMARK ASHLAND 133'21**
Male BFL 133J May 24 2021

2217374



G A R ASHLAND
Sire: **BENCHMARK ASHLAND 229'18**
G A R ANTICIPATION N506
G A R ANTICIPATION N506
G A R INNOVATION 3002G
Dam: **BENCHMARK WENDY 155'17 (1964469)**
BENCHMARK WENDY 94 DDF

G A R EARLY BIRD
CHAIR ROCK AMBUSH 1018
G A R ANTICIPATION
G A R CONTRAST L234
SYDGEN TRUST 6228
GOODE MANDATE 1751
G A R PREDESTINED
PRIDE N083 OF WHITESTONE

CARCASS	
EPD'S:	
MARB	+1.38
REA	+0.41
CW	+45
FAT	+0.047
ACTUAL:	
%IMF	7.91
REA	1.10
RIB FAT	0.43
LMY	58.4%

PERFORMANCE							EPD's					
AOD	BW	205D	365D	ADG	F:G	RFI	CE	BW	WW	YW	RFI	CBI
4	81	716	1294	3.81	6.22:1	-1.26	+6.0	+1.8	+80	138	-0.14	+283

SEPTEMBER 2022 EPD RANKING:

Top 1% Marbling
Top 1% Weaning Weight
Top 1% Yearling Weight

Tremendous IMF Scan at 7.91%. This guy will get the job done with calves that will gain and grade!



LOT 15

LORI CHOGI



1716 20th Ave, Coaldale, AB
403.345.4848 info@schwartzcoaldale.com

M
&
K

HOME
SALES

CELEBRATING
OVER
60
YEARS

Est. 1958

A Name You Can Trust

Providing Quality Modular and
Ready to Move Housing for Alberta
Since 1958

1-800-334-7059

2930 Fairway Street South Lethbridge, Alberta
www.mandkhomesales.com

BULL SIRED BY BENCHMARK ASHLAND 229'18



LOT 16

BENCHMARK ASHLAND 135'21

Male BFL 135J May 25 2021

2231974



LOT 16

G A R ASHLAND
 Sire: **BENCHMARK ASHLAND 229'18**
 G A R ANTICIPATION N506
 G A R CONTRAST L234
 C R A BEXTOR 872 5205 608
 G A R PROPHET
 Dam: **BENCHMARK EVERELDA ENTENSE 29'14 (1792954)**
 TWIN VALLEY PRECISION E161
 C F EVERELDA ENTENSE 1903
 C O EVERELDA ENTENSE 9060

CARCASS	
EPD'S:	
MARB	+0.99
REA	+0.73
CW	+ 64
FAT	+0.023
ACTUAL:	
%IMF	5.69
REA	0.99
RIB FAT	0.40
LMY	59.3%

PERFORMANCE							EPD's					
AOD	BW	205D	365D	ADG	F:G	RFI	CE	BW	WW	YW	RFI	CBI
7	94	732	1438	4.28	6.46:1	+0.37	+4.0	+3.1	+86	+145	-0.37	+263

SEPTEMBER 2022 EPD RANKING:		
Top 1% Weaning Weight	Top 1% Milk	Top 4% Marbling
Top 1% Yearling Weight	Top 2% Carcass Weight	Top 10% Ribeye

From an own daughter of Prophet, who is out of our very first donor 1903. 29'14 has sons at CJD and at Bettcher's with two daughters in production at Benchmark*.

LOT 17

BENCHMARK ASHLAND 136'21

Male BFL 136J May 25 2021

2217402



G A R ASHLAND
 Sire: **BENCHMARK ASHLAND 229'18**
 G A R ANTICIPATION N506
 G A R CONTRAST L234
 G A R PROPHET
 Dam: **BENCHMARK EVERELDA 167'16 (1899396)**
 G A R PROPHET
 BENCHMARK EVERELDA ENTENSE 29'14
 C F EVERELDA ENTENSE 1903

CARCASS	
EPD'S:	
MARB	+1.30
REA	+0.26
CW	+44
FAT	+0.089
ACTUAL:	
%IMF	8.02
REA	1.01
RIB FAT	0.58
LMY	53.8%

PERFORMANCE							EPD's					
AOD	BW	205D	365D	ADG	F:G	RFI	CE	BW	WW	YW	RFI	CBI
5	85	693	1303	3.55	6.27:1	-1.90	+12.0	+1.8	+69	+114	+0.06	+209

SEPTEMBER 2022 EPD RANKING:	
Top 1% Marbling	Top 5% Weaning Weight
Top 4% Calving Ease	Top 10% Yearling Weight

Lot 16 and Lot 17 are special! If your focus is on the phenotypic side of things or on the EPD side of things these two bulls have it all covered Take a special look here!

BULL SIRED BY BENCHMARK ASHLAND 229'18

LOT 18

BENCHMARK ASHLAND 137'21
Male POKE 137J May 25 2021

2219091



G A R ASHLAND
Sire: **BENCHMARK ASHLAND 229'18**
G A R ANTICIPATION N506
G A R PREDESTINED
BENCHMARK PREDESTINED 8301
Dam: **BENCHMARK NALIE 49'14 (1809849)**
BENCHMARK NALIE 784 NHF
BENCHMARK NALIE 5212

CARCASS	
EPD'S:	
MARB	+0.83
REA	+0.29
CW	+32
FAT	+0.049
ACTUAL:	
%IMF	4.34
REA	1.10
RIB FAT	0.41
LMY	58.2%

PERFORMANCE							EPD's					
AOD	BW	205D	365D	ADG	F:G	RFI	CE	BW	WW	YW	RFI	CBI
7	77	667	1217	4.30	6.13:1	+1.92	+10.0	+0.5	+63	+107	+0.44	+232

SEPTEMBER 2022 EPD RANKING:

Top 7% Marbling
Top 9% Calving Ease
Top 10% Weaning Weight
Top 15% Yearling Weight
Top 15% Birth Weight

From an own daughter of Catalyst who served us well over several years.

LOT 19

BENCHMARK ASHLAND 150'21
Male BFL 150J May 30 2021

2231987



G A R ASHLAND
Sire: **BENCHMARK ASHLAND 229'18**
G A R ANTICIPATION N506
CONNEALY IN SURE 8524
Dam: **G A R IN SURE N1122 DDF (2145958)**
G A R BEXTOR N48
G A R EARLY BIRD
CHAIR ROCK AMBUSH 1018
G A R ANTICIPATION
MYTTY IN FOCUS
ENTREENA OF CONANGA 657
C R A BEXTOR 872 5205 608
G A R 1407 NEW DESIGN 3294

CARCASS	
EPD'S:	
MARB	+1.01
REA	+0.60
CW	+33
FAT	+0.005
ACTUAL:	
%IMF	4.34
REA	1.13
RIB FAT	0.33
LMY	59.7%

PERFORMANCE							EPD's					
AOD	BW	205D	365D	ADG	F:G	RFI	CE	BW	WW	YW	RFI	CBI
8	82	631	1184	4.54	5.02:1	-0.55	+10.0	+0.2	+59	+98	+0.10	+210

SEPTEMBER 2022 EPD RANKING:

Top 3% Marbling
Top 9% Calving Ease
Top 15% Milk
Top 20% Weaning Weight
Top 25% Ribeye
Top 30% Yearling Weight

N1122, the dam, is non other than granddam of Tender Beef. Besides Tender Beef, she has a daughter retained and a son at Bruce and Devin Hogg.

LOT 20

BENCHMARK ASHLAND 161'21
Male BFL 161J June 7, 2021

2231984



G A R ASHLAND
Sire: **BENCHMARK ASHLAND 229'18**
G A R ANTICIPATION N506
G A R DAYBREAK 6860
Dam: **BENCHMARK ERELITE 134'13 DDF (1741674)**
BENCHMARK ERELITE 042
G A R EARLY BIRD
CHAIR ROCK AMBUSH 1018
G A R ANTICIPATION
G A R CONTRAST L234
MCC DAYBREAK
G A R OBJECTIVE 277L AMF DDC
ALC BIG EYE D09N
BENCHMARK ERELITE 6225

CARCASS	
EPD'S:	
MARB	+1.01
REA	+0.74
CW	+51
FAT	-0.003
ACTUAL:	
%IMF	3.60
REA	1.10
RIB FAT	0.26
LMY	62.1%

PERFORMANCE							EPD's					
AOD	BW	205D	365D	ADG	F:G	RFI	CE	BW	WW	YW	RFI	CBI
8	89	695	1275	3.95	6.16:1	+0.49	+5.0	+3.1	+81	+132	+0.16	+264

SEPTEMBER 2022 EPD RANKING:

Top 1% Weaning Weight
Top 1% Yearling Weight
Top 3% Marbling
Top 9% Ribeye
Top 15% Carcass Weight
Top 15% Fat

The dam here is designated Premier by the Cdn Angus Association. This is no small feat! She has sons at DriL and Ward Bros. and three daughters have been retained.



**TABER CATTLE
CLINIC**

403-223-2000
office@tabercattleclinic.com
6303 55 St. Taber, AB



PO Box 657
Picture Butte, Alberta T0K 1V0
UFA.com

DON & COLLEEN SHIMEK
Agents
Shimek Service Ltd

DIRECT 403-732-4224
CELL 403-308-1322
1-877-732-4343

REFERENCE SIRE

H P C A CAN'T MISS M17



CAA
GENOMIC
ENHANCED
EPDs

CE
+11.0

BW
+1.2

WW
+52

YW
+94

CW
+37

MARB
+1.21

REA
+0.77

DOC
+33

CBI
+291

PERF	AOD	BW	205D	365D
	ET	61	731	1360

MITTY IN FOCUS
 CONNEALY IN SURE 8524
 ENTREENA OF CONANGA 657
G A R SURE FIRE
 G A R NEW DESIGN 5050
 CHAIR ROCK 5050 G A R 8086
 CHAIR ROCK GRID MAKER 2107
SIRE: H P C A CAN'T MISS M17 (2049517)
 EXAR UPSHOT 0562B
 EXAR DENVER 2002B
 EXAR ROYAL LASS 1067
MLC RITA 4142
 HPCA 5050 351
 G A R NEW DESIGN 5050
 G A R PROMISE 2908

Can't Miss comes to us from Kenny Hinkle's Prime Cut Angus in Missouri. He is an own son of G A R Sure Fire, a Select Sire's Stalwart, who has had 4,686 progeny ultrasound evaluated and 290 actual carcasses evaluated. Can't Miss is from an EXAR Denver Donor at Hinkle's. Can't Miss at ultrasound had a 10.3% IMF with a ribeye of 14.8 sq. in. or 1.12 sq. in. per cwt. He is a carcass bull, a calving ease bull, and leaves some wonderful hard-working daughters.

OWNED WITH HINKLE PRIME CUT ANGUS
7 SONS SELL

- Avg. BW: 82 lbs
- Avg. 205D: 635 lbs
- Avg. 365D: 1217 lbs

SEPTEMBER 2022 EPD RANKING:

- | | |
|---------------------|--------------------------|
| Top 1% Marbling | Top 8% Milk |
| Top 1% Docility | Top 8% Ribeye |
| Top 1% Scrotal | Top 20% Heifer Pregnancy |
| Top 6% Calving Ease | |

BULL SIRED BY H P C A CAN'T MISS M17

LOT 21

BENCHMARK ON TARGET 59'21

2217393

Male BFL 59J April 27 2021



G A R SURE FIRE
 CONNEALY IN SURE 8524
 CHAIR ROCK 5050 G A R 8086
Sire: H P C A CAN'T MISS M17 DDF (2049517)
 EXAR DENVER 2002B
 MLC RITA 4142 DDF
 H P C A 5050 351
 SUMMITCREST HIGH PRIME 0H29
 THREE TREES NEXT STEP
 G A R PRECISION 706
Dam: BENCHMARK ERELITE 31'17 (1957886)
 G A R PROPHET
 BENCHMARK ERELITE 56'15
 BENCHMARK ERELITE 134'13

CARCASS	
EPD'S:	
MARB	+1.21
REA	+0.70
CW	+47
FAT	+0.033
ACTUAL:	
%IMF	5.56
REA	0.97
RIB FAT	0.47
LMY	56.3%

PERFORMANCE							EPD's					
AOD	BW	205D	365D	ADG	F:G	RFI	CE	BW	WW	YW	RFI	CBI
4	94	585	1181	3.46	6.27:1	-1.19	+0.0	+4.3	+69	+121	+0.07	+319

SEPTEMBER 2022 EPD RANKING:		
Top 1% Marbling	Top 5% Yearling Weight	Top 20% Carcass Weight
Top 5% Weaning Weight	Top 10% Ribeye	

His calves will gain and grade. Note the marbling EPD.

LOT 22

BENCHMARK ON TARGET 68'21

2217411

Male BFL 68J May 2 2021



G A R SURE FIRE
 CONNEALY IN SURE 8524
 CHAIR ROCK 5050 G A R 8086
Sire: H P C A CAN'T MISS M17 DDF (2049517)
 EXAR DENVER 2002B
 MLC RITA 4142
 H P C A 5050 351
 G A R NEW DESIGN 5050
 G A R BASELINE AB297 DDF
 G A R OBJECTIVE 648S AMF
Dam: BENCHMARK BARD ROSE 188'15 (1879329)
 G A R EFFICIENCY 7295
 BENCHMARK BARD ROSE 9256
 BENCHMARK BARD ROSE 4189

CARCASS	
EPD'S:	
MARB	+1.07
REA	+0.76
CW	+36
FAT	+0.034
ACTUAL:	
%IMF	7.09
REA	1.09
RIB FAT	0.44
LMY	57.9%

PERFORMANCE							EPD's					
AOD	BW	205D	365D	ADG	F:G	RFI	CE	BW	WW	YW	RFI	CBI
6	70	593	1155	3.22	6.64:1	-1.23	+13.0	-1.6	+45	+79	-0.08	+278

SEPTEMBER 2022 EPD RANKING:		
Top 1% Milk	Top 2% Birth Weigh	Top 8% Ribeye
Top 2% Calving Ease	Top 3% Marbling	Top 10% Mat Calving Ease

Heifer Bull Here !!



BULL SIRED BY H P C A CAN'T MISS M17



LOT 23

BENCHMARK ON TARGET 69'21
Male LAA 69J May 2 2021

2219108

LOT 23



Sire: **H P C A CAN'T MISS M17 DDF (2049517)**
 CONNEALY IN SURE 8524
 G A R SURE FIRE
 CHAIR ROCK 5050 G A R 8086
 EXAR DENVER 2002B
 MLC RITA 4142 DDF
 H P C A 5050 351
 SITZ UPWARD 307R
 TRIARA MADE TO ORDER 366Y
 RBF RITA 6A98 4TV7 2A63
 Dam: **BENCHMARK LAVENDER LADY 20'14 (1779919)**
 STANDARD HILL PAYOFF 20P
 BENCHMARK LAVENDER LADY 851
 BENCHMARK LAVENDER LADY 5160

CARCASS	
EPD'S:	
MARB	+0.96
REA	+0.80
CW	+40
FAT	+0.027
ACTUAL:	
%IMF	4.48
REA	1.09
RIB FAT	0.35
LMY	60.1%

PERFORMANCE						EPD's						
AOD	BW	205D	365D	ADG	F:G	RFI	CE	BW	WW	YW	RFI	CBI
7	80	577	1144	2.93	7.23:1	-0.50	+11.0	+0.5	+51	+98	-0.02	+258

SEPTEMBER 2022 EPD RANKING:

Top 4 % Marbling
 Top 6% Ribeye
 Top 6% Calving Ease
 Top 6% Maternal Calving Ease

The dam has a son at Black Coullee and a Tender Beef daughter at Iron Horse Cattle Co.

LOT 24

BENCHMARK ON TARGET 96'21
Male BFL 96J May 10 2021

2217305



Sire: **H P C A CAN'T MISS M17 DDF (2049517)**
 CONNEALY IN SURE 8524
 G A R SURE FIRE
 CHAIR ROCK 5050 G A R 8086
 EXAR DENVER 2002B
 MLC RITA 4142 DDF
 H P C A 5050 351
 BASIN PAYWEIGHT 1682
 BRUIN BENZ 5361
 BRUIN 6759 FOREVER LADY 3327
 Dam: **BENCHMARK QUEEN 222F (2145950)**
 TRIARA MADE TO ORDER 366Y
 BENCHMARK QUEEN 222'14
 BENCHMARK QUEEN 0207

CARCASS	
EPD'S:	
MARB	+0.75
REA	+0.52
CW	+60
FAT	+0.058
ACTUAL:	
%IMF	5.77
REA	1.09
RIB FAT	0.35
LMY	60.2%

PERFORMANCE						EPD's						
AOD	BW	205D	365D	ADG	F:G	RFI	CE	BW	WW	YW	RFI	CBI
3	77	693	1267	2.91	7.26:1	-2.43	+7.0	+0.9	+64	+120	-0.15	260

SEPTEMBER 2022 EPD RANKING:

Top 1% Milk
 Top 4% Carcass Weight
 Top 6% Yearling Weight
 Top 6% Maternal Calving Ease
 Top 10% Weaning Weight
 Top 10% Marbling

The Benz dam calved at 20 months of age and then calved less than 12 months later. Fertility!!

BULL Sired BY H P C A CAN'T MISS M17

LOT 25 BENCHMARK ON TARGET 138'21

2217308

Male BFL 138J May 25 2021



CONNEALY IN SURE 8524
 G A R SURE FIRE CHAIR ROCK 5050 G A R 8086
Sire: H P C A CAN'T MISS M17 DDF (2049517)
 EXAR DENVER 2002B
 MLC RITA 4142 DDF
 H P C A 5050 351
 BASIN PAYWEIGHT 1682
 BRUIN BENZ 5361
Dam: BENCHMARK ELBA 193F (2145947)
 WHITESTONE BARON W279
 BENCHMARK ELBA 01
 BENCHMARK ELBA 814

CARCASS	
EPD'S:	
MARB	+1.22
REA	+0.60
CW	+45
FAT	+0.076
ACTUAL:	
%IMF	8.46
REA	1.04
RIB FAT	0.44
LMY	56.8%

PERFORMANCE							EPD's					
AOD	BW	205D	365D	ADG	F:G	RFI	CE	BW	WW	YW	RFI	CBI
3	78	641	1211	4.54	5.02:1	-0.55	+7.0	+1.9	+65	+112	-0.08	+261

SEPTEMBER 2022 EPD RANKING:	
Top 1% Marbling	Top 10% Weaning Weight
Top 6% Maternal Calving Ease	Top 10% Yearling Weight

Three Quarter brother to Lot 24. Terrific scan on this guy!

LOT 26 BENCHMARK ON TARGET 172'21

2249745

Male BFL 172J June 15 2021



CONNEALY IN SURE 8524
 G A R SURE FIRE CHAIR ROCK 5050 G A R 8086
Sire: H P C A CAN'T MISS M17 DDF (2049517)
 EXAR DENVER 2002B
 MLC RITA 4142 DDF
 H P C A 5050 351
 B/R DESTINATION 727-928
 G A R END POINT 5122
Dam: BENCHMARK BELLE 170'18 DDF (2029813)
 BENCHMARK ABERDEEN 188'12
 BENCHMARK BELLE 124'15
 BENCHMARK BELLE 225'12

CARCASS	
EPD'S:	
MARB	+1.51
REA	-0.76
CW	+53
FAT	-0.004
ACTUAL:	
%IMF	7.89
REA	1.00
RIB FAT	0.38
LMY	57.9%

PERFORMANCE							EPD's					
AOD	BW	205D	365D	ADG	F:G	RFI	CE	BW	WW	YW	RFI	CBI
3	95	753	1375	3.55	6.27:1	-1.19	+9.0	+1.9	+65	+112	-0.01	+368

SEPTEMBER 2022 EPD RANKING:		
Top 1% Marbling	Top 8% Ribeye	Top 10% Weaning Weight
Top 1% Cdn Balanced Index	Top 10% Yearling Weight	Top 10% Carcass Weight
Top 5% Milk	Top 10% Calving Ease	

This guy does everything right. Great Scan and Great Weaning and Yearling Weights. A full brother works for Shane Schmid. His calves gain and grade! A great partner.

LOT 27 BENCHMARK ON TARGET 176'21

2231968

Male BFL176J June 15 2021



CONNEALY IN SURE 8524
 G A R SURE FIRE CHAIR ROCK 5050 G A R 8086
Sire: H P C A CAN'T MISS M17 DDF (2049517)
 EXAR DENVER 2002B
 MLC RITA 4142 DDF
 H P C A 5050 351
 G A R INGENUITY
 GAR INGENUITY J2024
Dam: BENCHMARK LADY HEATHER 132'14 (1779837)
 BENCHMARK NEXT STEP 8289
 BENCHMARK LADY HEATHER 141'11
 BENCHMARK COUNTESS 9175

CARCASS	
EPD'S:	
MARB	+0.95
REA	+0.48
CW	+34
FAT	+0.034
ACTUAL:	
%IMF	5.06
REA	0.94
RIB FAT	0.37
LMY	56.7%

PERFORMANCE							EPD's					
AOD	BW	205D	365D	ADG	F:G	RFI	CE	BW	WW	YW	RFI	CBI
7	80	603	1187	3.99	5.20:1	-1.94	+11.0	+1.5	+61	+115	-0.18	+269

SEPTEMBER 2022 EPD RANKING:	
Top 4% Marbling	Top 9% Yearling Weight
Top 6% Calving Ease	Top 15% Weaning Weight

Lady Heather 132'14 has a son at Bahama Farming and an A011 daughter works at Benchmark*



BULLSEYE

Great neighbours know when to listen.

ATB has a deeply rooted relationship with Alberta's farmers. It remains at the heart of everything we do today. It starts with really listening—because not only are we Albertans, we're also your neighbours. Our dedicated experts can create custom solutions that will help your farm and our province grow. After all, we're in this together.

Stop by to talk with us today.

atb.com/agriculture

REFERENCE SIRE

GAR PHOENIX



CAA
GENOMIC
ENHANCED
EPDs

CE
+12.0

BW
+1.1

WW
+86

YW
+154

CW
+84

MARB
+1.17

REA
+1.11

DOC
+20

CBI
+320

PERF	AOD	BW	205D	365D
	ET	72	756	1378

CONNELY IN SURE 8524

SIRE: GAR SURE FIRE

CHAIR ROCK 5050 GAR 8086

SIRE: GAR PHOENIX (2077113)

G A R PROPHET

Dam: GAR PROPHET N744

G A R DAYBREAK 440

MITTY IN FOCUS

ENTREENA OF CONANGA 657

G A R NEW DESIGN 5050

CHAIR ROCK GRID MAKER 2107

C R A BEXTOR 872

G A R OBJECTIVE 1885

MCC DAYBREAK

G A R YIELD GRADE N76

Phoenix was the Lot 1 bull in the spring Gardiner sale bringing \$130,000. He is a Select Sires Stalwart, featuring top calving ease, early growth and end product merit. His calves at Benchmark® came easy and really do grow, plus have great feet and leg structure. His sons show extra frame and have been readily accepted in the industry.

4 SONS SELL

- Avg. BW: 77 lbs
- Avg. 205D: 626 lbs.
- Avg. 365D: 1330 lbs

SEPTEMBER 2022 EPD RANKING:

Top 1% Weaning Weight
Top 1% Yearling Weight
Top 1% Carcass Weight
Top 1% Ribeye
Top 1% Scrotal

Top 2% Marbling
Top 4% Calving Ease
Top 7% Residual ADG
Top 10% CDN Balanced Index

BULLS SIRED BY G A R PHOENIX

LOT 28

BENCHMARK PHOENIX 7'21

Male BFL 7J March 31 2021

2220943



G A R SURE FIRE CONNEALY IN SURE 8524
 ROCK 5050 G A R 8086 DDC
Sire: G A R PHOENIX (2077113)
 G A R PROPHET
 G A R PROPHET N744 OSF
 G A R DAYBREAK 440
 B/R NEW DESIGN 036
 G A R NEW DESIGN 5050
Dam: G A R 5050 NEW DESIGN 2132 DDF (1723493)
 G A R PRECISION 706
 S S OBJECTIVE T510 OT26
 G A R OBJECTIVE 2670 DDC
 G A R PREDESTINED N408

CARCASS	
EPD'S:	
MARB	+0.74
REA	+1.01
CW	+69
FAT	-0.036
ACTUAL:	
%IMF	3.05
REA	0.95
RIB FAT	0.33
LMY	62.7%

PERFORMANCE							EPD's					
AOD	BW	205D	365D	ADG	F-G	RFI	CE	BW	WW	YW	RFI	CBI
N/A	70	627	1361	4.89	5.40:1	-0.11	+9.0	+0.8	+76	+137	+0.05	+306

SEPTEMBER 2022 EPD RANKING:

Top 1% Weaning Weight	Top 1% Ribeye	Top 10% Calving Ease
Top 1% Yearling Weight	Top 1% Fat	Top 15% Cdn Balanced Index
Top 1% Carcass Weight	Top 10% Marbling	

From our embryo program. Lots of Top 1% here!

LOT 29

BENCHMARK PHOENIX 20'21

Male BFL 20J April 12 2021

2232005



G A R SURE FIRE CONNEALY IN SURE 8524
 ROCK 5050 G A R 8086 DDC
Sire: G A R PHOENIX (2077113)
 G A R PROPHET
 G A R PROPHET N744 OSF
 G A R DAYBREAK 440
 G A R PROPHET
 BENCHMARK FOUNDATION 213A
Dam: BENCHMARK ISABELLA 182F (2145961)
 C F EVERELDA ENTENSE 1903
 G A R BASELINE AB297
 BENCHMARK ISABELLA 244'16
 BENCHMARK ISABELLA 213'12

CARCASS	
EPD'S:	
MARB	+0.67
REA	+0.39
CW	+67
FAT	+0.001
ACTUAL:	
%IMF	4.56
REA	0.96
RIB FAT	0.34
LMY	61.1%

PERFORMANCE							EPD's					
AOD	BW	205D	365D	ADG	F-G	RFI	CE	BW	WW	YW	RFI	CBI
2	72	651	1322	4.28	6.52:1	+2.23	+5.0	+1.7	+84	+152	+0.11	+246

SEPTEMBER 2022 EPD RANKING:

Top 1% Weaning Weight	Top 5% Milk
Top 1% Yearling Weight	Top 15% Marbling
Top 1% Carcass Weight	

From a two-year-old heifer sired by the Basin Angus Herd Sire, Foundation 213A. Be sure to check out Lots 16 and 17 with Everelda Entense 1903 featured.



LOT 28

BULLS SIRED BY G A R PHOENIX

LOT 30

BENCHMARK PHOENIX 23'21

Male BFL 23J April 12 2021

2217271



G A R SURE FIRE CONNEALY IN SURE 8524
 ROCK 5050 G A R 8086 DDC
Sire: G A R PHOENIX (2077113)
 G A R PROPHET
 G A R PROPHET N744 OSF
 G A R DAYBREAK 440
 G A R NEW DESIGN 5050
 G A R BASELINE AB297
Dam: BENCHMARK BEAUTY 116'19 (2105644)
 BENCHMARK MICAH 247'13
 BENCHMARK BEAUTY 44'16
 BENCHMARK BEAUTY 212'11

CARCASS	
EPD'S:	
MARB	+1.28
REA	+0.86
CW	+77
FAT	-0.006
ACTUAL:	
%IMF	6.20
REA	1.00
RIB FAT	0.37
LMY	61.3%

PERFORMANCE							EPD's					
AOD	BW	205D	365D	ADG	F:G	RFI	CE	BW	WW	YW	RFI	CBI
2	83	661	1410	4.37	5.42:1	-2.01	+7.0	+3.4	+86	+152	+0.03	+361

SEPTEMBER 2022 EPD RANKING:	
Top 1% Weaning Weight	Top 1% Canadian Balance Index
Top 1% Yearling Weight	Top 1% Marbling
Top 1% Carcass Weight	Top 3% Ribeye

Extra Carcass weight on these Phoenix sons. Nice scan with a 13.9 Sq. In. Ribeye and a 6.20 IMF score.



LOT 30

LOT 31

BENCHMARK PHOENIX 43'21

Male BFL 43J April 22 2021

2217278



G A R SURE FIRE CONNEALY IN SURE 8524
 ROCK 5050 G A R 8086 DDC
Sire: G A R PHOENIX (2077113)
 G A R PROPHET
 G A R PROPHET N744 OSF
 G A R DAYBREAK 440
 BASIN PAYWEIGHT 1682
 BRUIN BENZ 5361
Dam: BENCHMARK BLACKCAP 96'19 (2106080)
 BRUIN 6759 FOREVER LADY 3327
 G A R PROPHET
 BENCHMARK BLACKCAP 226'14
 AAF BLACKCAP 15F

CARCASS	
EPD'S:	
MARB	+0.55
REA	+0.68
CW	+63
FAT	+0.027
ACTUAL:	
%IMF	3.33
REA	1.18
RIB FAT	0.26
LMY	63.2%

PERFORMANCE							EPD's					
AOD	BW	205D	365D	ADG	F:G	RFI	CE	BW	WW	YW	RFI	CBI
2	83	566	1225	3.95	6.37:1	0.99	+7.0	++1.7	+71	+128	+0.32	+250

SEPTEMBER 2022 EPD RANKING:		
Top 2% Yearling Weight	Top 3% Weaning Weight	Top 15% Milk
Top 3% Carcass Weight	Top 15% Ribeye	

From a two-year-old heifer, she is by the 1682 son, Bruin Benz, that serves us well.

BULLS SIRED BY BENCHMARK TENDER BEEF 1'19

Benchmark Tender Beef 11'17 Reference Grand Sire



LOT 32

BENCHMARK TENDER BEEF 56'21 2223584
Male LAA 56J April 27, 2021



G A R PROPHET
BENCHMARK TENDER BEEF 11'17
Sire: BENCHMARK TENDER BEEF 1'19 (2105439)
WR JOURNEY-1X74
BENCHMARK BLACKCAP 2'17
BENCHMARK BLACKCAP 119'15

G A R PROPHET
G A R PROPHET A011 DDF
Dam: BENCHMARK PRIDE 149'16 (1899419)
G A R 1407 NEW DESIGN 3064
G A R DAYBREAK 6860
BENCHMARK PRIDE 80'14
BENCHMARK PRIDE 86'12

CARCASS	
EPD'S:	
MARB	+1.19
REA	+0.86
CW	+56
FAT	-0.017
ACTUAL:	
%IMF	6.52
REA	1.09
RIB FAT	0.27
LMY	63.7%

PERFORMANCE							EPD's					
AOD	BW	205D	365D	ADG	F:G	RFI	CE	BW	WW	YW	RFI	CBI
5	77	634	1287	4.59	5.98:1	+1.23	+15.0	-2.1	+61	+114	+0.39	+293

SEPTEMBER 2022 EPD RANKING:		
Top 1% Calving Ease	Top 1% Maternal Calving Ease	Top 6% Fat
Top 1% Birth Weight	Top 1% Milk	Top 10% Yearling Weight
Top 1% Marbling	Top 3% Ribeye	Top 15% Weaning Weight

This guy checks all the boxes.



LOT 32

BULLS SIRED BY BENCHMARK TENDER BEEF 1'19

LOT 33

BENCHMARK TENDER BEEF 79'21

2219004

Male BFL 79J May 6, 2021



	G A R PROPHET	
	BENCHMARK TENDER BEEF 11'17	
	BENCHMARK QUEEN 259'14	
Sire:	BENCHMARK TENDER BEEF 1'19 (2105439)	
	WR JOURNEY-1X74	
	BENCHMARK BLACKCAP 2'17	
	BENCHMARK BLACKCAP 119'15	
	B/R DESTINATION 727-928	
	G A R END POINT 5122	
	G A R 28 AMBUSH 1949	
Dam:	BENCHMARK NEW LASSIE 76'17 (1964419)	
	GAR INGENUITY J2024	
	BENCHMARK NEW LASSIE 92'14	
	BENCHMARK NEW LASSIE 82'11	

CARCASS	
EPD'S:	
MARB	+1.47
REA	+0.77
CW	+61
FAT	-0.022
ACTUAL:	
%IMF	9.30
REA	0.97
RIB FAT	0.35
LMY	60.6%

PERFORMANCE							EPD's					
AOD	BW	205D	365D	ADG	F:G	RFI	CE	BW	WW	YW	RFI	CBI
4	84	700	1376	5.16	5.01:1	-1.19	+8.0	+2.1	+66	+120	-0.02	+325

SEPTEMBER 2022 EPD RANKING:		
Top 1% Marbling	Top 6% Yearling Weight	Top 10% Milk
Top 4% Carcass Weight	Top 8% Ribeye	Top 15% Calving Ease
Top 4% Fat	Top 9% YW weaning Weight	

A maternal sister works at Iron Horse Cattle Co. Marbling scan with a ratio of 189!!

LOT 34

BENCHMARK TENDER BEEF 87'21

2219006

Male BFL 87J May 7, 2021

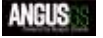

	G A R PROPHET	
	BENCHMARK TENDER BEEF 11'17	
	BENCHMARK QUEEN 259'14	
Sire:	BENCHMARK TENDER BEEF 1'19 (2105439)	
	WR JOURNEY-1X74	
	BENCHMARK BLACKCAP 2'17	
	BENCHMARK BLACKCAP 119'15	
	G A R PROPHET	
	G A R PROPHET A011	
	G A R 1407 NEW DESIGN 3064	
Dam:	BENCHMARK LADY KATHLEEN 18'17 DDF (1957876)	
	TRIARA MADE TO ORDER 366Y	
	BENCHMARK LADY KATHLEEN 81'15	
	BENCHMARK LADY KATHLEEN 02	

CARCASS	
EPD'S:	
MARB	+0.83
REA	+0.62
CW	+38
FAT	-0.006
ACTUAL:	
%IMF	4.02
REA	1.28
RIB FAT	0.27
LMY	62.3%

PERFORMANCE							EPD's					
AOD	BW	205D	365D	ADG	F:G	RFI	CE	BW	WW	YW	RFI	CBI
4	80	621	1005	-	-	-	+14.0	+0.4	+57	+104	-	+316

SEPTEMBER 2022 EPD RANKING:		
Top 1% Calving Ease	Top 1% Milk	Top 15% Fat
Top 1% Maternal Calving Ease	Top 7% Marbling	Top 15% Birth Weight

An Arsenal maternal sister serves at Benchmark*



LOT 33

BULLS SIRED BY G A R HOME TOWN

LOT 35 **BENCHMARK HOMETOWN 15'21** 2220905
Male BFL 15J April 10, 2021



G A R ASHLAND
Sire: **G A R HOME TOWN (2138145)**
CHAIR ROCK SURE FIRE 6095
CHAIR ROCK SURE FIRE G A R SURE FIRE
CHAIR ROCK PROGRESS 3005
G A R MOMENTUM
Dam: **BENCHMARK QUEEN 229'14 (2145970)**
G A R PROPHET 922
G A R PROPHET
G A R OBJECTIVE 1209

CARCASS	
EPD'S:	
MARB	+1.49
REA	+0.65
CW	+27
FAT	-0.013
ACTUAL:	
%IMF	6.37
REA	1.20
RIB FAT	0.30
LMY	61.8%

PERFORMANCE							EPD's					
AOD	BW	205D	365D	ADG	F:G	RFI	CE	BW	WW	YW	RFI	CBI
7	75	454	991	2.76	7.37:1	+0.82	+13.0	-0.2	+57	+101	+0.29	+358

SEPTEMBER 2022 EPD RANKING:

Top 1% Marbling
Top 1% Milk
Top 2% Calving Ease
Top 2% Cdn Balanced Index
Top 9% Fat
Top 10% Birth Weight
Top 15% Ribeye

We lost the dam of this guy, thus his lower than expected WW and YW. Breeding some heifers?

LOT 36 **BENCHMARK HOME TOWN 34'21** 2217287
Male BFL 34J April 15 2021



G A R ASHLAND
Sire: **G A R HOME TOWN (2138145)**
CHAIR ROCK SURE FIRE 6095
CHAIR ROCK SURE FIRE G A R SURE FIRE
CHAIR ROCK PROGRESS 3005
V A R GENERATION 2100
EF PRIME QUARTER 5369
EF RITA 3422 DDF
Dam: **BENCHMARK NEW LASSIE 74'19 (2106065)**
GAR INGENUITY J2024
BENCHMARK NEW LASSIE 92'14
BENCHMARK NEW LASSIE 82'11

CARCASS	
EPD'S:	
MARB	+1.51
REA	+0.77
CW	+32
FAT	-0.001
ACTUAL:	
%IMF	6.08
REA	1.25
RIB FAT	0.27
LMY	63.1%

PERFORMANCE							EPD's					
AOD	BW	205D	365D	ADG	F:G	RFI	CE	BW	WW	YW	RFI	CBI
2	57	532	1100	4.34	4.75:1	-1.52	+20.0	-3.0	+55	+103	-0.02	+343

SEPTEMBER 2022 EPD RANKING:

Top 1% Marbling
Top 1% Calving Ease
Top 1% Birth Weight
Top 3% Mat Calving Ease
Top 5% Milk
Top 5% Cdn Balanced Index
Top 8% Ribeye

A couple of heifer bulls in Lots 35 and 36 and the heifer calves will make excellent cows!

G A R HOME TOWN
~ Reference Sire



PROCORRAL



CLEANERS

403-892-2397

proccorralcleaners.com

D & S INSURANCE SERVICES

JON MCKENZIE

304 - 2 STREET, P.O. BOX 357, WARNER, AB. T0K2L0
Telephone: (403) 642-2032 Fax: (403)642-2112
E-MAIL: jon@dsinsuranceservices.ca

Toll Free in Alberta: 1-888-488-0188

FOR ALL YOUR INSURANCE NEEDS
FARM • HOME • AUTO • TRAVEL • LIVESTOCK • EQUINE • HAIL

BULLS SIRED BY G A R COMBUSTION

LOT 37

BENCHMARK COMBUSTION 19'21 2232003

Male BFL 19J April 11 2021



G A R SURE FIRE
 Sire: **G A R COMBUSTION (2138149)**
 G A R MOMENTUM 1724
 EF PRIME QUARTER 5369
 Dam: **BENCHMARK ESTER 194F (2145953)**
 BENCHMARK ESTER 228'16
 CONNEALY IN SURE 8524
 CHAIR ROCK 5050 G A R 8086
 G A R MOMENTUM
 G A R 28 AMBUSH M91
 V A R GENERATION 2100
 EF RITA 3422
 BENCHMARK TOP SHELF 220'14
 BENCHMARK ESTER 211'14

CARCASS	
EPD'S:	
MARB	+1.29
REA	+0.52
CW	+53
FAT	+0.062
ACTUAL:	
%IMF	8.66
REA	1.00
RIB FAT	0.47
LMY	58.3%

PERFORMANCE							EPD's					
AOD	BW	205D	365D	ADG	F:G	RFI	CE	BW	WW	YW	RFI	CBI
2	64	642	1358	3.15	7.77:1	0.73	+10.0	+0.8	+68	+126	+0.24	+337

SEPTEMBER 2022 EPD RANKING:		
Top 1% Marbling	Top 6% Cdn Balanced Index	Top 10% Mat Calving Ease
Top 3% Yearling Weight	Top 9% Calving Ease	Top 10% Carcass Weight
Top 6% Weaning Weight		

Heifer bull here. We really like the Prime Quarter daughters, as evident by Lot 37. Check the IMF scan of 8.66!



LOT 37

G A R COMBUSTION Reference Sire



LOT 38

BENCHMARK COMBUSTION 40'21 2217291

Male BFL 40J April 22, 2021



G A R SURE FIRE
 Sire: **G A R COMBUSTION (2138149)**
 G A R MOMENTUM 1724
 EF PRIME QUARTER 5369
 Dam: **BENCHMARK LADY HEATHER 51'19 (2106057)**
 BENCHMARK LADY HEATHER 91
 CONNEALY IN SURE 8524
 CHAIR ROCK 5050 G A R 8086
 G A R MOMENTUM
 G A R 28 AMBUSH M91
 V A R GENERATION 2100
 EF RITA 3422
 G A R EFFICIENCY 7295
 BENCHMARK LADY HEATHER 6293

CARCASS	
EPD'S:	
MARB	+1.12
REA	+0.59
CW	+38
FAT	+0.048
ACTUAL:	
%IMF	4.94
REA	1.11
RIB FAT	0.40
LMY	59.8%

PERFORMANCE							EPD's					
AOD	BW	205D	365D	ADG	F:G	RFI	CE	BW	WW	YW	RFI	CBI
2	65	585	1246	4.43	6.24:1	3.00	+13.0	-0.4	+63	+115	+0.56	+299

SEPTEMBER 2022 EPD RANKING:		
Top 2% Marbling	Top 8% Milk	Top 9% Birth Weight
Top 2% Calving Ease	Top 9% Yearling Weight	Top 10% Weaning Weight
Top 3% Mat Calving Ease		

Again a heifer bull from a Prime Quarter two-year-old. Nice scan for IMF and Ribeye.

BULLS SIRED BY BASIN PAYWEIGHT 1682

LOT 39

BENCHMARK PAYMASTER 18'21

2221145

Male BFL 18J April 11 2021



VERMILION PAYWEIGHT J847
 BASIN PAYWEIGHT 006S
 BASIN LUCY
Sire: BASIN PAYWEIGHT 1682 (2010588)
 HARB PENDLETON 765 J H
 21AR O LASS 7017
 21AR O LASS F24A
 MCC DAYBREAK
 G A R ANTICIPATION
 G A R 5050 NEW DESIGN 0530
Dam: G A R ANTICIPATION N506 (2030260)
 CONNEALY CONTRAST
 G A R CONTRAST L234
 G A R OBJECTIVE 0J06

CARCASS	
EPD'S:	
MARB	+0.61
REA	+0.64
CW	+65
FAT	+0.029
ACTUAL:	
%IMF	5.61
REA	0.95
RIB FAT	0.45
LMY	59.4%

PERFORMANCE							EPD's					
AOD	BW	205D	365D	ADG	F:G	RFI	CE	BW	WW	YW	RFI	CBI
ET	82	630	1413	4.54	5.42:1	-1.32	+9.0	+1.1	+82	+136	+0.05	+314

SEPTEMBER 2022 EPD RANKING:

Top 1% Weaning Weight
 Top 1% Yearling Weight
 Top 1% Milk
 Top 2% Carcass Weight
 Top 10% Calving Ease
 Top 15% Marbling
 Top 20% Ribeye

This guy does push the scale down as will his calves. From our embryo program.

LOT 40

BENCHMARK PAYMASTER 32'21

2221147

Male BFL 32J April 15 2021



VERMILION PAYWEIGHT J847
 BASIN PAYWEIGHT 006S
 BASIN LUCY
Sire: BASIN PAYWEIGHT 1682 (2010588)
 HARB PENDLETON 765 J H
 21AR O LASS 7017
 21AR O LASS F24A
 MCC DAYBREAK
 G A R ANTICIPATION
 G A R 5050 NEW DESIGN 0530
Dam: G A R ANTICIPATION N506 (2030260)
 CONNEALY CONTRAST
 G A R CONTRAST L234
 G A R OBJECTIVE 0J06

CARCASS	
EPD'S:	
MARB	+0.84
REA	+0.85
CW	+55
FAT	-0.006
ACTUAL:	
%IMF	4.19
REA	1.06
RIB FAT	0.25
LMY	64.1%

PERFORMANCE							EPD's					
AOD	BW	205D	365D	ADG	F:G	RFI	CE	BW	WW	YW	RFI	CBI
ET	79	600	1229	4.32	6.18:1	-0.88	+7.0	+1.3	+67	+120	+0.27	+374

SEPTEMBER 2022 EPD RANKING:

Top 1% Cdn Balanced Index
 Top 4% Ribeye
 Top 5% Milk
 Top 6% Yearling Weight
 Top 7% Marbling
 Top 7% Weaning Weight
 Top 9% Carcass Weight

These 1682 sons are typical 1682s, thick and deep and both with nice birth weights.



BASIN PAYWEIGHT ~ Reference Sire

BULLS SIRED BY 44 ARSENAL



44 ARSENAL Reference Sire

LOT 41 BENCHMARK ARSENAL 11'21 Male BFL11J April 07 2021

2221149



BALDRIDGE WAYLON W34 GAR-EGL PROTEGE
BALDRIDGE BLACKCAP T163
Sire: 44 ARSENAL 4W07
DZ ND 5050 OF15 G A R NEW DESIGN 5050
DZ TOTAL 8T05
MCC DAYBREAK
G A R ANTICIPATION
Dam: G A R ANTICIPATION N506 (2030260) G A R 5050 NEW DESIGN 0530
CONNEALY CONTRAST
G A R CONTRAST L234
G A R OBJECTIVE 0J06

CARCASS	
EPD'S:	
MARB	+0.72
REA	+1.03
CW ¹¹	+54
FAT	-0.024
ACTUAL:	
%IMF	6.01
REA	1.09
RIB FAT	0.35
LMY	63.5%

PERFORMANCE							EPD's					
AOD	BW	205D	365D	ADG	F:G	RFI	CE	BW	WW	YW	RFI	CBI
ET	83	655	1353	3.42	7.26:1	+0.77	+6.0	+2.2	+64	+112	-0.04	+299

SEPTEMBER 2022 EPD RANKING:

Top 1% Ribeye Top 10% Marbling Top 10% Yearling Weight
Top 3% Fat Top 10% Weaning Weight Top 10% Carcass Weight

Checks a few critical boxes. His calves will gain and grade.

LOT 42 BENCHMARK ARSENAL 14'21 Male BFL 14J April 8 2021

2220964



BALDRIDGE WAYLON W34 GAR-EGL PROTEGE
BALDRIDGE BLACKCAP T163
Sire: 44 ARSENAL 4W07
DZ ND 5050 OF15 G A R NEW DESIGN 5050
DZ TOTAL 8T05
MCC DAYBREAK
G A R ANTICIPATION
Dam: G A R ANTICIPATION N506 (2030260) G A R 5050 NEW DESIGN 0530
CONNEALY CONTRAST
G A R CONTRAST L234
G A R OBJECTIVE 0J06

CARCASS	
EPD'S:	
MARB	+1.04
REA	+0.73
CW ¹¹	+40
FAT	-0.004
ACTUAL:	
%IMF	7.90
REA	1.25
RIB FAT	0.37
LMY	63.6%

PERFORMANCE							EPD's					
AOD	BW	205D	365D	ADG	F:G	RFI	CE	BW	WW	YW	RFI	CBI
ET	80	602	1269	3.17	6.63:1	-2.80	+13.0	+0.2	+60	+105	-0.40	+323

SEPTEMBER 2022 EPD RANKING:

Top 2% Calving Ease Top 10% Cdn Balanced Indes Top 20% Weaning Weight
Top 3% Marbling Top 10% Maternal Calving Ease Top 20% Yearling Weight
Top 10% Ribeye

These Arsenals bring some stoutness to some pretty good carcass numbers.

DW DAVIDSON & WILLIAMS LLP
Serving Southern Alberta for 135 Years

WE OFFER SERVICES IN THE AREAS OF:

- Real Estate • Corporate & Commercial
- Personal Injury • Labour & Employment
- Wills & Estates • Farm & Agricultural
- Litigation & Dispute Resolution • Family Law

501 4 STREET SOUTH • LETHBRIDGE, ALBERTA • (403) 328-1766 • www.dwilliam.pro

BGV BOW VALLEY GENETICS

Embryo Transfer Services
IVF
Certified for Exportable Embryo Production
Export Qualified Semen Collection and Bull Stud
Owner's Use Semen
Embryo & Semen Storage & Distribution

Ph: 587.887.1934
Email: embryos@bowvalleygenetics.com
Web: www.bowvalleygenetics.com

BULLS SIRED BY G A R VELOCITY



G A R VELOCITY ~ Reference Sire

BENCHMARK VELOCITY 103'21

LOT 43

Male BFL 103J May 11 2021

2217458



BRIDGES VELOCITY
 Sire: **G A R VELOCITY W507 (2024584)**
 G A R OBJECTIVE A706
 G A R END POINT 5122
 Dam: **BENCHMARK TIBBIE D 128'15 DDF (1834882)**
 BENCHMARK TIBBIE D 18'12
 TIBBIE D OF ALCAN 145

G A R MOMENTUM
 BRIDGES DAYBREAK 2100
 S S OBJECTIVE T510
 G A R INTEGRITY T465
 B/R DESTINATION 727-928
 G A R 28 AMBUSH 1949
 G A R PREDESTINED
 TIBBIE D OF ALCAN 145

CARCASS	
EPD'S:	
MARB	+1.17
REA	+1.18
CW	+58
FAT	-0.021
ACTUAL:	
%IMF	4.61
REA	1.15
RIB FAT	0.31
LMY	62.7%

PERFORMANCE							EPD's					
AOD	BW	205D	365D	ADG	F:G	RFI	CE	BW	WW	YW	RFI	CBI
6	88	642	1299	3.44	7.86:1	2.76	+6.0	+1.8	+70	+129	+0.70	+306

SEPTEMBER 2022 EPD RANKING:		
Top 1% Ribeye	Top 2% Yearling Weight	Top 4% Fat
Top 2% Marbling	Top 4% Weaning Weight	Top 6% Carcass Weight

Marbling and Ribeye both well over +1.00



Terry Russell
Kathy Russel

Milk River
Home Hardware
Building Centre
109 Centre Ave.
Box 240
Milk River
Alberta

T 403-647-3636
403-647-3515

C 403-642-7820
F 403-647-3533
mrlumber@mrcable.ca

*Looking for fence posts & barb wire?
We have a great selection of peeled, Spray Lakes posts available!*



Munton &
Michaelis

Professional Corporation

Chartered Professional Accountants





REFERENCE SIRE

BENCHMARK PLATINUM 83'18



LSF MEW Platinum 5660C pictured

CAA
GENOMIC
ENHANCED
EPDs

CE
+9.0

BW
-0.7

WW
+53

YW
+99

CW
+29

MARB
+0.47

REA
+0.42

DOC
+13

CBI
+293

PERF	AOD	BW	205D	365D
	2	85	502	1124

S A V FINAL ANSWER 0035
BROWN INCREDABULL Z7277

RED BROWN MS MISSION
Sire: RED LSF MEW PLATINUM 5660C OSF

LCC NEW STANDARD
BROWN MS NEW STANDARD A7053

RED BBROWN MS DESTINATION

SIRE: RED BENCHMARK PLATINUM 83'18 (2062227)

RED BROWN ALLIANCE

REDD DUN BETTER A500

RED LSF SWEETNESS
Dam: RED BENCHMARK QUEEN 111'16

RRRED BASIN EXT

RED BENCHMARK QUEEN 31'14

RED QUEEN OF BENCHMARK 984

Platinum 83'18 is a home grown bull that just kept getting better and better so we put him with 20 cows with amazing results. He features some main stay black genetics such as Final Answer, New Design 1407, Traveler 6807, Future Direction, EXT and others. You will like bulls by him, they are as stout a set of red bulls that we have ever offered!

8 SONS SELL

- Avg. BW: 82 lbs
- Avg. 205D: 718 lbs
- Avg. 365D: 1,242 lbs

SEPTEMBER 2022 EPD RANKING:

- | | |
|---------------------------|-----------------------|
| Top 1% Cdn Balanced Index | Top 7% Marbling |
| Top 1% Heifer Pregnancy | Top 8% Weaning Weight |
| Top 1% Scrotal | Top 10% Calving Ease |
| Top 3% Yearling Weight | Top 10% Residual ADG |
| Top 6% Mat Calving Ease | |

BULLS SIRED BY RED BENCHMARK PLATINUM 83'18

LOT 44 **RED BENCHMARK PLATINUM 06J** 2212005
Male BFR 06J March 28 2021



BROWN INCREDABULL Z7277
RED LSF MEW PLATINUM 5660C OSF
BROWN MS NEW STANDARD7053
Sire: RED BENCHMARK PLATINUM 83'18 (2062227)
RED DUNN BETTER A500
RED BENCHMARK QUEEN 111'16
RED BENCHMARK QUEEN 31'14
RED 3JG-MEW GRIDIRON 806U
RED LSF MEW GAME CHANGER 1613Y
RED MEW ELIZABETH 710T
Dam: RED BENCHMARK FAYETTE 6'14 OSF (1783315)
RED COMPASS DIVIDEND 467M
RED FAYETTE OF BENCHMARK 424 OSC
RED FAYETTE OF BENCHMARK 262

CARCASS	
EPD's:	
MARB	+0.49
REA	+0.45
CW	+34
FAT	+0.004
ACTUAL:	
%IMF	3.89
REA	1.08
RIB FAT	0.34
LMY	58.5%

PERFORMANCE							EPD's					
AOD	BW	205D	365D	ADG	F-G	RFI	CE	BW	WW	YW	RFI	CBI
7	82	705	1275	3.11	6.07:1	-4.70	+2.0	+1.7	+51	+95	-0.39	+227

SEPTEMBER 2022 EPD RANKING:

Top 5% Yearling Weight	Top 10% Weaning Weight	Top 25% Ribeye
Top 6% Marbling	Top 10% Carcass Weight	

These Platinum's do push the scale down with added barrel and thickness. Note the 424 cow, she is dam of the Denver Champion. Benchmark Better Beef.

LOT 45 **RED BENCHMARK PLATINUM 07J** 2212053
Male BFR 07J March 29 2021



BROWN INCREDABULL Z7277
RED LSF MEW PLATINUM 5660C OSF
BROWN MS NEW STANDARD7053
Sire: RED BENCHMARK PLATINUM 83'18 (2062227)
RED DUNN BETTER A500
RED BENCHMARK QUEEN 111'16
RED BENCHMARK QUEEN 31'14
RED LSF MEW GAME CHANGER 1613Y
RED BENCHMARK TRANSITION 10'14
RED BENCHMARK LANA 60'11
Dam: RED BENCHMARK DURUBA 41'17 (1961738)
WK DATELINE 7270
RED BENCHMARK DURUBA 07
RED DURUBA BENCHMARK 311

CARCASS	
EPD's:	
MARB	+0.19
REA	+0.42
CW	+32
FAT	-0.003
ACTUAL:	
%IMF	5.07
REA	1.06
RIB FAT	0.29
MY	60.0%

PERFORMANCE							EPD's					
AOD	BW	205D	365D	ADG	F-G	RFI	CE	BW	WW	YW	RFI	CBI
4	85	716	1285	3.06	7.73:1	+0.15	+2.0	+1.2	+51	+85	+0.31	+243

SEPTEMBER 2022 EPD RANKING:

Top 10% Weaning Weight	Top 10% Yearling Weight
------------------------	-------------------------

A maternal brother works for Milford Colony.

Grain Seeding

Corn Planting

Packing & Bagging

SLINGERLAND CATTLE LTD.
Custom Ag Services

KEN SLINGERLAND
403-382 8815
slcattle02@gmail.com

Silaging: Alfalfa, Barley, Wheat, Corn



OUR READERS ARE YOUR CUSTOMERS!
Your advertising expenditure is reaching a potential bull buyer!

Alberta BEEF

BEEF illustrated

- No wasted circulation to farm homes NOT in the beef business
- Delivered by addressed mail ONLY
- Well-read and respected publications!

Call 403-250-1090 or visit beefnews.com for more information.

BULLS Sired BY RED BENCHMARK PLATINUM 83'18

LOT 46

RED BENCHMARK PLATINUM 012J 2212020

Male BFR 012J April 03 2021

ANGUS

	BROWN INCREDABULL Z7277	
	RED LSF MEW PLATINUM 5660C OSF	
	BROWN MS NEW STANDARD A7053	
Sire:	RED BENCHMARK PLATINUM 83'18 (2062227)	
	RED DUNN BETTER A500	
	RED BENCHMARK QUEEN 111'16	
	RED BENCHMARK QUEEN 31'14	
	RED BROWN ALLIANCE X7795	
	RED DUNN BETTER A500	
	RED LSF SWEETNESS J1358 P4085	
Dam:	RED BENCHMARK VIRGINADOL 43'15 (1834139)	
	RED LCHMAN COPPER ROB 1204D	
	RED BENCHMARK VIRGINADOL 13'12	
	RED BENCHMARK VIRGINADOLL 050	

CARCASS	
EPD's:	
MARB	+0.14
REA	+0.17
CW	+19
FAT	+0.044
ACTUAL:	
%IMF	3.55
REA	0.97
RIB FAT	0.39
LMY	60.1%

PERFORMANCE							EPD's					
AOD	BW	205D	365D	ADG	F:G	RFI	CE	BW	WW	YW	RFI	CBI
6	89	753	1216	3.15	8.14:1	+1.90	-1.0	+0.4	+43	+72	+0.34	+168

SEPTEMBER 2022 EPD RANKING:		
Top 2% Milk	Top 30% Weaning Weight	Top 35% Yearling Weight

A maternal brother works for Jeff & Bonnie Resch. Lot 46 is as thick and deep as they come. Checkout Lot 58.

LOT 47

RED BENCHMARK PLATINUM 015J 2212047

Male BFR 015J April 22 2021

ANGUS

	BROWN INCREDABULL Z7277	
	RED LSF MEW PLATINUM 5660C OSF	
	BROWN MS NEW STANDARD A7053	
Sire:	RED BENCHMARK PLATINUM 83'18 (2062227)	
	RED DUNN BETTER A500	
	RED BENCHMARK QUEEN 111'16	
	RED BENCHMARK QUEEN 31'14	
	RED BROWN ALLIANCE X7795	
	RED DUNN BETTER A500	
	RED LSF SWEETNESS J1358 P4085	
Dam:	RED BENCHMARK SUNFLOWER 114'16 (1940582)	
	RED BASIN EXT 45T5	
	RED BENCHMARK SUNFLOWER 20'14	
	RED BENCHMARK SUNFLOWER 8118	

CARCASS	
EPD's:	
MARB	+0.65
REA	+0.30
CW	+38
FAT	+0.020
ACTUAL:	
%IMF	4.97
REA	0.92
RIB FAT	0.54
LMY	56.3%

PERFORMANCE							EPD's					
AOD	BW	205D	365D	ADG	F:G	RFI	CE	BW	WW	YW	RFI	CBI
5	84	792	1367	3.24	7.74:1	+1.30	+10.0	+0.3	+57	+97	+0.22	+285

SEPTEMBER 2022 EPD RANKING:		
Top 1% Marbling	Top 4% Yearling Weight	Top 8% Carcass Weight
Top 1% Cdn Balanced Index	Top 6% Mat Calving Ease	Top 9% Calving Ease
Top 4% Weaning Weight		

Number one weaning weight out of eleven ratioing 110, as well as, number one on yearling weight ratioing 110.



LOT 47

BULLS Sired BY RED BENCHMARK PLATINUM 83'18

LOT 48

RED BENCHMARK PLATINUM 016J 2212021

Male BFR 016J April 23 2021

ANGUS

	BROWN INCREDABULL Z7277		
	RED LSF MEW PLATINUM 5660C OSF		
	BROWN MS NEW STANDARD A7053		
Sire:	RED BENCHMARK PLATINUM 83'18 (2062227)		
	RED DUNN BETTER A500		
	RED BENCHMARK QUEEN 111'16		
	RED BENCHMARK QUEEN 31'14		
	RED 3JG-MEW GRIDIRON 806U		
	RED LSF MEW GAME CHANGER 1613Y		
	RED MEW ELIZABETH 710T		
Dam:	RED BENCHMARK SAMARIA 61'15 (1834084)		
	RED TED GLACIER MARIAS 103N		
	RED SAMARIA OF BENCHMARK 843		
	RED SAMARIA OF BENCHMARK 329		

CARCASS
EPD'S:
MARB +0.07
REA +0.33
CW +30
FAT +0.030
ACTUAL:
%IMF 2.61
REA 1.00
RIB FAT 0.37
LMY 59.9%

PERFORMANCE							EPD's					
AOD	BW	205D	365D	ADG	F:G	RFI	CE	BW	WW	YW	RFI	CBI
6	82	720	1199	3.37	7.63:1	+1.50	+9.0	-0.5	+54	+82	+0.56	+233

SEPTEMBER 2022 EPD RANKING:		
Top 7% Weaning Weight	Top 10% Calving Ease	Top 15% Yearling Weight

A son of Samaria 61'15 works for Ferne R Boreleau Inc. in Quebec and two daughters in production at Benchmark.

LOT 49

RED BENCHMARK PLATINUM 018J 2212057

Male BFR 018J April 27 2021

ANGUS

	BROWN INCREDABULL Z7277		
	RED LSF MEW PLATINUM 5660C OSF		
	BROWN MS NEW STANDARD A7053		
Sire:	RED BENCHMARK PLATINUM 83'18 (2062227)		
	RED DUNN BETTER A500		
	RED BENCHMARK QUEEN 111'16		
	RED BENCHMARK QUEEN 31'14		
	RED LSF MEW GAME CHANGER 1613Y		
	RED BENCHMARK TRANSITION 10'14		
	RED BENCHMARK LANA 60'11		
Dam:	RED BENCHMARK LULANNA 52'17 (1961747)		
	RED BADLANDS NET WORTH 23U		
	RED BENCHMARK LULANNA 6'11		
	RED LULANNA OF BENCHMARK 8114		

CARCASS
EPD'S:
MARB +0.23
REA +0.18
CW +15
FAT +0.042
ACTUAL:
%IMF 2.46
REA 1.07
RIB FAT 0.40
LMY 58.4%

PERFORMANCE							EPD's					
AOD	BW	205D	365D	ADG	F:G	RFI	CE	BW	WW	YW	RFI	CBI
4	69	640	1079	-	-	-	+6.0	+0.5	+41	+68	-	+218

SEPTEMBER 2022 EPD RANKING:		
Top 1% Heifer Pregnancy	Top 10% Mat Calving Ease	Top 20% Birth Weight

The dam here has a son at Phil Rowland's and another son at Milford Colony.

LOT 50

RED BENCHMARK PLATINUM 019J 2212011

Male BFR 019J April 28 2021

ANGUS

	BROWN INCREDABULL Z7277		
	RED LSF MEW PLATINUM 5660C OSF		
	BROWN MS NEW STANDARD A7053		
Sire:	RED BENCHMARK PLATINUM 83'18 (2062227)		
	RED DUNN BETTER A500		
	RED BENCHMARK QUEEN 111'16		
	RED BENCHMARK QUEEN 31'14		
	RED 3JG-MEW GRIDIRON 806U		
	RED LSF MEW GAME CHANGER 1613Y		
	RED MEW ELIZABETH 710T		
Dam:	RED BENCHMARK LAKIMA 70'14 (1777853)		
	RED 5L TRAVLIN EXP 1892-6295		
	RED BENCHMARK LAKIMA 871		
	RED LAZY MC LAKIMA 11F		

CARCASS
EPD'S:
MARB -0.09
REA +0.58
CW +43
FAT -0.001
ACTUAL:
%IMF 2.76
REA 0.99
RIB FAT 0.31
LMY 62.1%

PERFORMANCE							EPD's					
AOD	BW	205D	365D	ADG	F:G	RFI	CE	BW	WW	YW	RFI	CBI
7	88	730	1302	2.54	9.21:1	+0.62	+6.0	+1.2	+60	+105	+0.31	+257

SEPTEMBER 2022 EPD RANKING:		
Top 1% Yearling Weight	Top 3% Carcass Weight	Top 10% Cdn Balanced Index
Top 2% Weaning Weight	Top 7% Ribeye	

A maternal sister is in production at Benchmark and a maternal sister was a 4-H project for Alyssa Groves.

LOT 51

RED BENCHMARK PLATINUM 020J 2212063

Male BFR 020J May 5 2021

ANGUS

	BROWN INCREDABULL Z7277		
	RED LSF MEW PLATINUM 5660C OSF		
	BROWN MS NEW STANDARD A7053		
Sire:	RED BENCHMARK PLATINUM 83'18 (2062227)		
	RED DUNN BETTER A500		
	RED BENCHMARK QUEEN 111'16		
	RED BENCHMARK QUEEN 31'14		
	RED LSF MEW GAME CHANGER 1613Y		
	RED BENCHMARK TRANSITION 10'14		
	RED BENCHMARK LANA 60'11		
Dam:	RED BENCHMARK PRINCESS 67'17 (1961755)		
	RED 5L NORSEMAN KING 2291		
	RED BENCHMARK PRINCESS 17'12		
	RED CROWFOOT PRINCESS 8126H		

CARCASS
EPD'S:
MARB +0.50
REA +0.32
CW +24
FAT +0.000
ACTUAL:
%IMF 3.32
REA 1.04
RIB FAT 0.30
LMY 61.6%

PERFORMANCE							EPD's					
AOD	BW	205D	365D	ADG	F:G	RFI	CE	BW	WW	YW	RFI	CBI
4	80	691	1215	3.53	7.07:1	+1.19	+7.0	-0.9	+45	+80	-0.39	+241

SEPTEMBER 2022 EPD RANKING:		
Top 5% Marbling	Top 15% Mat Calving Ease	Top 20% Calving Ease
Top 15% Birth Weight	Top 20% Yearling Weight	Top 20% Cdn Balanced Index

Note that the grand dam and great grand dam are designated Elite by the Canadian Angus Assoc.

**Benchmark Transition 10'14
Reference Grand Sire**



REFERENCE SIRE

RED LAUBACH DEEP END 7047



Bieber Deep End B597 pictured

LOT 52

RED BENCHMARK BIG TIMBER 24J

Male BFR 24J April 24 2021

2235531

RED BIEBER DEEP END B597
 Sire: **RED LAUBACH DEEP END 7047 (2024585)**
 RED HXC CONQUEST 4405P
 RED LAUBACH JODI 9018
 RED WHY 8000 WILLOW 7033
 RED BASIN EXT 45T5
 Dam: **RED BENCHMARK ESTY 53'14 (1777839)**
 RED 5L TRAVLIN EXP 1892-6295
 RED BENCHMARK ESTY 030
 RED ESTY OF BENCHMARK 620

CARCASS	
EPD'S:	
MARB	+0.65
REA	+0.54
CW	+43
FAT	+0.014
ACTUAL:	
%IMF	3.32
REA	1.02
RIB FAT	0.41
LMY	59.1%

PERFORMANCE							EPD's					
AOD	BW	205D	365D	ADG	F:G	RFI	CE	BW	WW	YW	RFI	CBI
7	88	652	1216	3.84	6.70:1	+0.72	+2.0	+1.2	+54	+97	+0.32	+238

SEPTEMBER 2022 EPD RANKING:		
Top 1% Marbling	Top 4% Yearling Weight	Top 10% Ribeye
Top 1% Heifer Pregnancy	Top 7% Weaning Weight	Top 20% Cdn Balanced Index
Top 3% Carcass Weight		

Note the Granddam Esty 030 is designated Premier by the Canadian Angus Assoc. The dam is a paternal sister to the Denver Grand Champion Benchmark Better Beef.

BOW VALLEY POWER

Local option for electricity and natural gas since 2010.

Switch and receive 1 FREE month of electricity consumption.

Visit www.bowvalleypower.net, referral code: BVP

Albertans Serving Alberta

Your green solution for sustainable management of organics. Pick-up & processing of offal, carcasses & deadstock.

Please call Ed @ (403) 328-1429 or send an e-mail to ed@ecbna.com

Leithbridge BIOGAS LP

BULLS SIRED BY RED LAUBACH DEEP END 7047

LOT 53

RED BENCHMARK BIG TIMBER 25J

Male BFR 25J April 24 2021

2235531

RED BIEBER ROLLIN DEEP Y118
 RED BIEBER DEEP END B597
 RED BIEBER LAURA 158W
Sire: RED LAUBACH DEEP END 7047 (2024585)
 RED HXC CONQUEST 4405P
 RED LAUBACH JODI 9018
 RED WHY 8000 WILLOW 7033
 RED LSF MEW GAME CHANGER 1613Y
 RED BENCHMARK TRANSITION 10'14
 RED BENCHMARK LANA 60'11
Dam: RED BENCHMARK BURGESS 90'17 (1961765)
 RED 5L TRAVLIN EXP 1892-6295
 RED BENCHMARK BURGESS 936
 RED BENCHMARK BURGESS 675

CARCASS	
EPD'S:	
MARB	+0.38
REA	+0.54
CW	+64
FAT	-0.024
ACTUAL:	
%IMF	3.34
REA	1.02
RIB FAT	0.42
LMY	59.7%

PERFORMANCE							EPD's					
AOD	BW	205D	365D	ADG	F:G	RFI	CE	BW	WW	YW	RFI	CBI
4	77	708	1335	3.55	7.09:1	+0.77	+7.0	+1.9	+77	+137	+0.53	+247

SEPTEMBER 2022 EPD RANKING:		
Top 1% Weaning Weight	Top 7% Fat	Top 15% Marbling
Top 1% Yearling Weight	Top 10% Ribeye	Top 15% Cdn Balanced Index
Top 1% Carcass Weight		

From another Transition daughter who has a daughter in production at Benchmark®. Note that Burgess 936 is "Elite".

LOT 53



LOT 54

RED BENCHMARK BIG TIMBER 33J

Male BFR 33J May 1 2021

2235536

RED BIEBER ROLLIN DEEP Y118
 RED BIEBER DEEP END B597
 RED BIEBER LAURA 158W
Sire: RED LAUBACH DEEP END 7047 (2024585)
 RED HXC CONQUEST 4405P
 RED LAUBACH JODI 9018
 RED WHY 8000 WILLOW 7033
 RED BROWN ALLIANCE X7795
 RED DUNN BETTER A500
 RED LSF SWEETNESS J1358 P4085
Dam: BENCHMARK BOTEET 6'18 (2019575)
 O C C EMBLAZON 854E
 BENCHMARK BOTEET 19'13
 RED PIE BOTEET 508

CARCASS	
EPD'S:	
MARB	+0.68
REA	+0.39
CW	+20
FAT	-0.030
ACTUAL:	
%IMF	3.30
REA	1.05
RIB FAT	0.25
LMY	62.2%

PERFORMANCE							EPD's					
AOD	BW	205D	365D	ADG	F:G	RFI	CE	BW	WW	YW	RFI	CBI
3	75	616	1127	4.41	4.81:1	-	+13.0	-0.8	+52	+81	-0.11	+216

SEPTEMBER 2022 EPD RANKING:		
Top 1% Marbling	Top 4% Fat	Top 20% Yearling Weight
Top 2% Calving Ease	Top 10% Weaning Weight	

Looking for calving ease, early growth and superior end-product merit? Lot 54 is bred for just that!

REFERENCE SIRE

RED FEDDES FRONTLINE Y33-8265



We Can...

MILT'S EARTHMOVING LTD.

- Dig Dugouts
- Clean Dugouts
- 60' Long Reach Excavator
- Scraper Work
- Drainage Ditches
- Basements
- PVC Line Installation
- Road Maintenance

Burdett, Alberta
Cell: (403) 382-7895 • Phone: (403) 833-3766 • Fax: (403) 833-3706

ICI
INDEPENDENT CROP INPUTS

Josh Iwan CCA

Cell: 403-634-2723
Office: 403-223-1325
Email: josh@icitaber.com

Box 4690
Taber, AB
T1G-2E1

BULLS SIRED BY RED FEDES FRONTLINE Y33-8265

LOT 55

RED BENCHMARK FRONTLINE 32J

Male BFR 32J April 30 2021

2235499



RED 5L OUT IN FRONT 1701-457B
 RED LASO FRONT ROW X37D
 RED LASO LEANNA BC114R
Sire: RED FEDES FRONTLINE Y33-8265 (2106310)
 RED MESSMER PACKER S008
 RED FEDES BLOCKANA Y33
 RED FEDES BLOCKANA 384
 RED BROWN COMMITMENT S7206
 RED LSF RAB COMMITMENT 2792Z
Dam: RED BENCHMARK LAKIMA 13'18 (2019580)
 RED LSF MEW GAME CHANGER 1613Y
 RED BENCHMARK LAKIMA 70'14
 RED BENCHMARK LAKIMA 871

CARCASS	
EPD'S:	
MARB	+0.20
REA	+0.50
CW	+35
FAT	-0.003
ACTUAL:	
%IMF	1.95
REA	1.03
RIBFAT	0.18
LMY	63%

PERFORMANCE							EPD's					
AOD	BW	205D	365D	ADG	F:G	RFI	CE	BW	WW	YW	RFI	CBI
3	80	657	1016	5.60	3.90:1	-0.95	+5.0	+0.0	+52	+79	+0.12	+243

SEPTEMBER 2022 EPD RANKING:		
Top 2% Milk	Top 10% Carcass Weight	Top 20% Yearling Weight
Top 10% Weaning Weight	Top 15% Ribeye	Top 20% Cdn Balanced Index
Top 10% Heifer Pregnancy		

The females by Commitment are moderate with beautiful udders and lots of milk, while Packer S008 is renown for his very feminine daughters.

LOT 56

RED BENCHMARK FRONTLINE 62J

Male BFR 62J May 18 2021

2235495



RED 5L OUT IN FRONT 1701-457B
 RED LASO FRONT ROW X37D
 RED LASO LEANNA BC114R
Sire: RED FEDES FRONTLINE Y33-8265 (2106310)
 RED MESSMER PACKER S008
 RED FEDES BLOCKANA Y33
 RED FEDES BLOCKANA 384
 RRED BROWN ALLIANCE X7795
 RED DUNN BETTER A500
 RED LSF SWEETNESS J1358 P408
Dam: RED BENCHMARK RUTH ANN 31'18 (2019595)
 RED BASIN EXT 45T5
 RED BENCHMARK RUTH ANN 61'13
 RED BAR-X EVITA 5R

CARCASS	
EPD'S:	
MARB	+0.48
REA	+0.75
CW	+44
FAT	-0.016
ACTUAL:	
%IMF	3.64
REA	1.14
RIBFAT	0.30
LMY	61.6%

PERFORMANCE							EPD's					
AOD	BW	205D	365D	ADG	F:G	RFI	CE	BW	WW	YW	RFI	CBI
3	95	674	1228	3.66	6.18:1	0.35	-2.0	+3.9	+69	+110	+0.16	+296

SEPTEMBER 2022 EPD RANKING:		
Top 1% Weaning Weight	Top 1% Cdn Balanced Index	Top 3% Carcass Weight
Top 1% Yearling Weight	Top 1% Ribeye	Top 6% Marbling

A daughter of Ruth Anne 31'18, her first calf, is retained at Benchmark® with a Merlin Bull calf this spring.

LOT 57

RED BENCHMARK FRONTLINE 85J

Male BFR 85J June 18 2021

2235474



RED 5L OUT IN FRONT 1701-457B
 RED LASO FRONT ROW X37D
 RED LASO LEANNA BC114R
Sire: RED FEDES FRONTLINE Y33-8265 (2106310)
 RED MESSMER PACKER S008
 RED FEDES BLOCKANA Y33
 RED FEDES BLOCKANA 384
 RED LSF JBOB EXPECTATION 6034S
 RED BENCHMARK ARRIVED 72'16
 RED BENCHMARK MAID 72'14
Dam: RED BENCHMARK SAMARIA 70'18 (2027298)
 RED LSF MEW GAME CHANGER 1613Y
 RED BENCHMARK SAMARIA 61'15
 RED SAMARIA OF BENCHMARK 843

CARCASS	
EPD'S:	
MARB	+0.23
REA	+0.72
CW	+56
FAT	-0.048
ACTUAL:	
%IMF	2.86
REA	1.11
RIBFAT	0.22
LMY	62.3%

PERFORMANCE							EPD's					
AOD	BW	205D	365D	ADG	F:G	RFI	CE	BW	WW	YW	RFI	CBI
3	99	735	1293	3.90	6.28:1	1.48	-6.0	+4.5	+64	+106	+0.44	+231

SEPTEMBER 2022 EPD RANKING:		
Top 1% Weaning Weight	Top 1% Carcass Weight	Top 1% Fat
Top 1% Yearling Weight	Top 1% Ribeye	Top 15% Milk

A daughter of Samaria 70'18 by EXT 45T5 is retained at Benchmark® with a Grindstone baby at side. Lot 57 checks a lot of boxes.

KENDRA DESIGN INC

GRAPHIC DESIGN

ads, logos, brochures, annual reports,
BULL SALE CATALOGUES and more!

kendradesign@gmail.com • 780-623-2387
kendradesign.myportfolio.com



BULLS SIRED BY RED GMRA TESLA 6214

LOT 58

RED BENCHMARK TESLA 10J

Male BFR 10J April 17 2021

2212138



RED MESSMER PACKER S008
 RED GMRA TRILOGY 0226
 RED GMRA LAKOTA 625
Sire: RED GMRA TESLA 6214 (2155763)
 RED GMRA PEACEMAKER 1216
 RED GMRA ANGIE ROSE 448
 RED GMRA ANGIE ROSE 967
 RED BIEBER DEEP END B597
 RED LAUBACH DEEP END 7047
 RED LAUBACH JODI 9018
Dam: RED BENCHMARK VIRGINADOL 32'19 (2112366)
 RED DUNN BETTER A500
 RED BENCHMARK VIRGINADOL 43'15
 RED BENCHMARK VIRGINADOL13'12

CARCASS	
EPD'S:	
MARB	+0.57
REA	+0.71
CW	+62
FAT	-0.019
ACTUAL:	
%IMF	3.21
REA	1.01
RIB FAT	0.35
LMY	61.2%

PERFORMANCE							EPD's					
AOD	BW	205D	365D	ADG	F:G	RFI	CE	BW	WW	YW	RFI	CBI
2	76	651	1343	4.30	619:1	0.93	+6.0	+0.4	+74	+136	+0.38	+230

SEPTEMBER 2022 EPD RANKING		
Top 1% Weaning Weight	Top 1% Milk	Top 3% Marbling
Top 1% Yearling Weight	Top 2% Ribeye	Top 10% Fat
Top 1% Carcass Weight		

We sampled Tesla on a few heifers with decent results, nice birth weights with decent get up and grow.

LOT 59

RED BENCHMARK TESLA 16J

Male BFR 16J April 22 2021

2212135



RED MESSMER PACKER S008
 RED GMRA TRILOGY 0226
 RED GMRA LAKOTA 625
Sire: RED GMRA TESLA 6214 (2155763)
 RED GMRA PEACEMAKER 1216
 RED GMRA ANGIE ROSE 448
 RED GMRA ANGIE ROSE 967
 RED BIEBER DEEP END B597
 RED LAUBACH DEEP END 7047
 RED LAUBACH JODI 9018
Dam: RED BENCHMARK FAYETTE 30'19 (2105189)
 RED DUNN BETTER A500
 RED BENCHMARK FAYETTE 7'15
 RED BENCHMARK FAYETTE 33'11

CARCASS	
EPD'S:	
MARB	+0.38
REA	+0.35
CW	+38
FAT	-0.010
ACTUAL:	
%IMF	3.12
REA	0.96
RIB FAT	0.27
LMY	61.4%

PERFORMANCE							EPD's					
AOD	BW	205D	365D	ADG	F:G	RFI	CE	BW	WW	YW	RFI	CBI
2	77	586	1215	4.74	5.23:1	0.35	+5.0	+0.3	+59	+110	+0.35	+225

SEPTEMBER 2022 EPD RANKING		
Top 1% Milk	Top 2% Weaning Weight	Top 15% Marbling
Top 1% Yearling Weight	Top 8% Carcass Weight	

Breeding some heifers? Take Lot 58 and 59 home for calving ease, early growth and carcass merit.

BALOG AUCTION SERVICES INC.

EXPERIENCE - ENTHUSIASM - INTENSITY - ABILITY

LETHBRIDGE, AB

Over 40 Years!

OF SERVING AGRICULTURAL PRODUCERS

IN WESTERN CANADA!

GIVE US A CALL FOR ALL YOUR LIVESTOCK, MACHINERY & REAL ESTATE REQUIREMENTS

BALOG AUCTION

403-329-1980

WEBSITE: WWW.BALOGAUCTION.COM

EMAIL: SOLD@BALOGAUCTION.COM

WESTERN STOCKMAN

WHERE COUNTRY IN THE CITY
 MAKES FOR GREAT FAMILY SHOPPING

SAVE 25% ONLINE
 CODE: SAVE25

LIMITED TIME OFFER

915 43 ST S, LETHBRIDGE, AB

WWW.WESTERNSTOCKMAN.CA

403-327-0731

BULLS SIRED BY RED BASIN EXT 45T5

LOT 60

RED BENCHMARK MONTANA 9J

Male BFR 9J April 17 2021

2212099



RED BASIN EXT 1925
 RED BASIN EXT 5233
 RED BASIN PRIMROSE 2043
Sire: RED BASIN EXT 45T5 AMF NHF OSF MAF (1429484)
 C A FUTURE DIRECTION 5321
 BASIN ROSE 710P
 RED BASIN ROSE F521
 BROWN INCREDABULL Z7277
 RED LSF MEW PLATINUM 5660C
 BROWN MS NEW STANDARD A7053
Dam: RED BENCHMARK SUNFLOWER 82'18 (2062226)
 RED DUNN BETTER A500
 RED BENCHMARK SUNFLOWER 114'16
 RED BENCHMARK SUNFLOWER 20'14

CARCASS	
EPD's:	
MARB	+0.56
REA	+0.80
CW	+38
FAT	-0.042
ACTUAL:	
%IMF	3.78
REA	1.27
RIB FAT	0.27
LMY	63.6%

PERFORMANCE							EPD's					
AOD	BW	205D	365D	ADG	F:G	RFI	CE	BW	WW	YW	RFI	CBI
3	71	637	1120	4.59	4.96:1	-0.84	+7.0	+1.7	+57	+93	-0.18	+296

SEPTEMBER 2022 EPD RANKING:

Top 1% Cdn Balanced Index	Top 1% Ribeye	Top 4% Weaning Weight
Top 1% Milk	Top 1% Fat	Top 6% Yearling Weight
Top 1% Heifer Pregnancy	Top 3% Marbling	Top 8% Carcass Weight

Study the numbers here! Efficient feed to gain, good growth and end product merit and keep the daughters!

LOT 61

RED BENCHMARK MONTANA 22J

Male BFR 22J April 24 2021

2212144



RED BASIN EXT 1925
 RED BASIN EXT 5233
 RED BASIN PRIMROSE 2043
Sire: RED BASIN EXT 45T5 AMF NHF OSF MAF (1429484)
 C A FUTURE DIRECTION 5321
 BASIN ROSE 710P
 RED BASIN ROSE F521
 RED BIEBER DEEP END B597
 RED LAUBACH DEEP END 7047
 RED LAUBACH JODI 9018
Dam: RED BENCHMARK VIRGINIADOLL 34'19 (2105196)
 RED BASIN EXT 45T5
 RED BENCHMARK VIRGINIADOLL 050
 RED VIRGINIADOLL BENCHMARK 353

CARCASS	
EPD's:	
MARB	+0.43
REA	+0.64
CW	+50
FAT	-0.006
ACTUAL:	
%IMF	3.25
REA	1.12
RIB FAT	0.28
LMY	61.8%

PERFORMANCE							EPD's					
AOD	BW	205D	365D	ADG	F:G	RFI	CE	BW	WW	YW	RFI	CBI
2	89	612	1138	4.41	4.73:1	-2.27	-0.5	+3.1	+58	+101	+0.00	+267

SEPTEMBER 2022 EPD RANKING:

Top 1% Carcass Weight	Top 4% Ribeye	Top 10% Heifer Pregnancy
Top 2% Yearling Weight	Top 10% Marbling	Top 15% Milk
Top 3% Weaning Weight		

We continue to use "Montana" for all the reasons noted above. Efficiency, growth, carcass quality with female merit in his offspring.

LOT 60



©2021 Vytelle, LLC. All rights reserved. Vytelle and its logo are trademarks of Vytelle, LLC. VY210209



Bruce Fletcher

Office: 403-223-1325
 Cell: 403-393-6497
 Email: bruce@icitaber.com

Box 4690
 Tober, AB
 T1G-2E1

LOT 62

RED BENCHMARK MERLIN 1J
Male BFR 1J April 02 2021

2219079



RED LJC MISSION STATEMENT P27
RED LJC MERLIN T179
RED BUF CRK REDPRIDE N179
Sire: RED WFL MERLIN 018A (2136568)
RED BROWN COMMITMENT S7206
RED WFL COMMITMENT 042Y
RED WFL JEWELMAKER 9024

RED H2R PROFITBUILDER B403
RED LIKE IT PROFIT BUILDER 7215E
RED TBJR REBELLA 409 OSF MAF
Dam: RED BENCHMARK MAID 11'19 (2105173)
RED DUNN BETTER A500
RED BENCHMARK MAID 89'17
RED BENCHMARK MAID 38'11

CARCASS	
EPD'S:	
MARB	+0.21
REA	+0.32
CW	+15
FAT	-0.002
ACTUAL:	
%IMF	3.25
REA	0.97
RIB FAT	0.29
LMY	61.7%

PERFORMANCE							EPD's					
AOD	BW	205D	365D	ADG	F:G	RFI	CE	BW	WW	YW	RFI	CBI
2	59	587	1180	3.95	5.97:1	0.35	+14	-3.3	+47	+82	+0.35	+251

SEPTEMBER 2022 EPD RANKING:		
Top 1% Calving Ease	Top 10% Cdn Balanced Index	Top 15% YearlingWeight
Top 2% Birth Weight	Top 15% Milk	Top 20% Weaning Weight
Top 10% Heifer Pregnancy		

Heifer Bull Extraordinaire!

LOT 63

RED BENCHMARK FRANCHISE 2J
Male BFR 2J April 12 2021

2212128



SPUR FRANCHISE 7070
SPUR FRANCHISE OF GARTON
H&H IRENE LASS 0135
Sire: RED 9 MILE FRANCHISE 6305 (2017139)
RED TR COLT 45 UT806
RED C-BAR ABIGRACE Y11
RED C-BAR & BROWN ABIGRACET714

RED BIEBER DEEP END B597
RED LAUBACH DEEP END 7047
RED LAUBACH JODI 9018
Dam: RED BENCHMARK FAYETTE 23'19 (2105184)
RED LSF MEW GAME CHANGER 1613Y
RED BENCHMARK FAYETTE 5'14 OSF
RED FAYETTE OF BENCHMARK 424

CARCASS	
EPD'S:	
MARB	+0.32
REA	+0.83
CW	+51
FAT	-0.006
ACTUAL:	
%IMF	2.74
REA	1.02
RIB FAT	0.22
LMY	63.8%

PERFORMANCE							EPD's					
AOD	BW	205D	365D	ADG	F:G	RFI	CE	BW	WW	YW	RFI	CBI
2	70	629	1236	4.34	5.98:1	1.17	+10.0	-0.7	+58	+111	+0.24	+280

SEPTEMBER 2022 EPD RANKING:		
Top 1% Yearling Weight	Top 1% Milk	Top 3% Cdn Balanced Index
Top 1% CarcassWeight	Top 3% Weaning Weight	Top 9% Calving Ease
Top 1% Ribeye		

Heifer Bull here. Do note Fayette 424, she dam of Benchmark Better Beef, Denver Grand Champion.

**Benchmark Better Beef
Denver Grand Champion**



LOT 64

RED BENCHMARK FOR PROFIT 26J
Male BFR 26J April 26 2021

2212052



RED LSF TAKEOVER 9943W
RED H2R PROFITBUILDER B403
RED BROWN MS P707 Y6674 Sire: Sire:
RED LIKE IT PROFIT BUILDER 7215E (2022641)
RED LSF HERDBUILDER 1058Y
RED TBJR REBELLA 409
RED RAISLAND REBELLA 146-737

RED BROWN COMMITMENT S7206
RED LSF RAB COMMITMENT 2792Z
RED BROWN MS MAKIN HAY W7901
Dam: Dam: RED BENCHMARK VIRGINIA 32'17 (1961730)
RED BASIN EXT 45T5
RED BENCHMARK VIRGINIADOLL 050
RED VIRGINIADOLL BENCHMARK 353

CARCASS	
EPD'S:	
MARB	+1.00
REA	-0.39
CW	+30
FAT	-0.019
ACTUAL:	
%IMF	5.82
REA	1.05
RIB FAT	0.35
LMY	60.6%

PERFORMANCE							EPD's					
AOD	BW	205D	365D	ADG	F:G	RFI	CE	BW	WW	YW	RFI	CBI
4	80	598	1234	3.37	8.18:1	3.35	+2.0	+1.6	+49	+92	+0.78	+248

SEPTEMBER 2022 EPD RANKING:		
Top 1% Marbling	Top 10% Milk	Top 15% Cdn Balanced Index
Top 7% Yearling Weight	Top 15% Weaning Weight	

A son of Virginia 32'17 works at Barrows Farm and Ranch and a daughter nurses a 2022 bull calf. Note the marbling on this guy. Very rare! Lot 64 is the #1 2021 born Red Angus bull on the Cdn Registry for marbling!



Feed Efficiency

I think we all know firsthand about feed efficiency. Some of us eat very little and still gain weight. Some of us wish we were inefficient such that we could eat whatever and how much we want and not gain weight. As with mankind, this principal applies clearly with our cattle. Some are efficient and some are not.

We often hear claims by producers that they have and produce efficient cattle. For the most part this is a statement made with no facts and proof behind it as they have not actually tested their cattle. How would one know? That is the dilemma we found ourselves in. We knew the weights on our cows, we knew the weights on our weaned calves and on our yearling cattle, but we had no idea on how to improve efficiency without individual testing of the animals. We run approximately 400 cows, we would like to run 440-450 cows on the same land base. We feed thousands of dollars of feed to our calves post-weaning, we want to decrease that cost by at least 10% and we want to have an improved environmental impact by decreasing methane and manure output.

By selecting for more feed efficient animals, we feel we can accomplish these goals. The goal as set by the National Beef Strategy is to be 15% more efficient within 5 years. We have a task set out for all of us. Improving the feed efficiency of your herd can result in big savings. 70 to 75 % of our total feed cost is used for maintenance of our cow herd. A 5% improvement in feed efficiency is considered to have an economic effect 4 times greater than a 5% improvement in average daily gain.

Residual Feed Intake (RFI) or net feed efficiency is defined as

the difference between an animal's actual feed intake and its expected feed requirement for maintenance and growth. RFI is the variation in feed intake that remains after the requirements for maintenance and growth have been met. Efficient animals eat less than expected and have a negative or low RFI, while inefficient animals eat more than expected and have a positive or high RFI. Research has indicated that this trait is quite heritable at about 40%. Dr. John Basarab and collaborating scientists from such countries as Australia, Ireland, Brazil and the US have concluded that selection for efficient RFI cattle will have no effect on growth, carcass yield and quality grade; will reduce feed intake at equal weight and ADG, will improve feed to gain ratio by 10-15%; will reduce net energy of maintenance and reduce the carbon footprint of cattle; and will reduce feed costs while having no effect on fertility of the cattle. A further explanation is given by Dr. John Genho of Neogen as follows:

FEED EFFICIENCY EPDS

Feed Efficiency EPDs attempt to capture an animal's genetic ability to put on more weight with less feed. While there are many ways to calculate feed efficiency (such as feed conversion ratio and residual average daily gain), an especially useful way is residual feed intake or RFI. RFI is feed intake adjusted for an animal's weight and gain. An animal that eats more also tends to be larger and gain more weight. By adjusting these factors out of an animal's intake measurement, we are able to better understand which animals process feed more efficiently.

We can then select for our typical growth traits (yearling weight, weaning weight, or post wean gain) and at the same time select for intake (in the form of RFI) and know that there is no double counting of an animal's size.

The RFI EPDs are expressed in actual lbs. of feed an animal will eat per day and is used in comparing one bull to another bull for the predictability of the RFI trait. Let's say we would expect bull X's calves to eat 0.65 lbs. more feed per day than the average calf his size, bull Y's to eat 0.35 lbs. less feed per day than the average calf his size, and bull Z's to eat 0.42 lbs. less feed than the average calf his size. Based on these numbers we would obviously choose bull Z as a sire.

Single trait selection is always a bad idea. RFI is no exception to this rule. Selection for RFI should always be done in conjunction with selection for growth. This selection for growth can be done by looking at weaning weight, yearling weight, or post wean gain EPDs. This will allow breeders to select animals that gain the most while consuming the least amount of feed.

This is cutting edge. You will not find this information in many Angus sale books in all of Canada. If you are serious about breeding economical, efficient, profitable cattle, I think you have to take a look. We have to get more efficient while yet producing a product the consumer is wanting and willing to pay for. We have provided from Grow Safe the RFI results for your consideration. The actual phenotypic results are the individuals' actual results on test. The RFI EPDs are a prediction of how the bulls' progeny will perform with respect to RFI and have been calculated by Dr. Genho.

Canadian Angus Association's Canadian Balanced Index

EPDs for new traits that are economically relevant are being developed and introduced to Canadian Angus members continuously.

Applying EPDs for all these traits into selection and breeding decisions can be challenging. Therefore, the Canadian Angus Association has worked to develop an Economic Selection Index that includes the EPDs for all traits. Traits are weighted in the index based on their economic impact on the Canadian commercial operation.

The Canadian Balanced Index is expressed in terms of Canadian dollars and reflects the expected difference in profits between bull's progeny.

For example:

Bull A CBI = \$250

Bull B CBI = \$150

On average, progeny from Bull A will be \$100 more profitable in a Canadian commercial operation than the progeny from Bull B.

The best way to get the Index for your animals is to Angus GS test them. Angus GS stands for Angus Genomic Selection. This name reflects the aim of the test to give Angus breeders and their customers a tool designed to guide whole-herd selection, mating management and breed-improvement decisions, as well as denoting the value of seedstock cattle. You can order your Angus GS test through the Association.

If you have any questions about the Canadian Angus Association's new Canadian Balanced Index please do not hesitate to contact Kajal Devani at kdevani@cdnangus.ca or 403-537-5604.

WHAT IS INCLUDED IN THE CANADIAN BALANCED INDEX:

GROWTH TRAITS

- Birth Weight EPD
- Weaning Weight EPD
- Milk EPD
- Yearling Weight EPD
- Residual Daily Gain EPD

MATERNAL TRAITS

- Calving Ease Direct EPD
- Calving Ease Maternal EPD
- Heifer Pregnancy EPD
- Docility EPD
- Mature Weight EPD
- Foot Angle EPD
- Foot Claw EPD

CARCASS TRAITS

- Marbling EPD
- Rib Eye Area EPD
- Back Fat EPD



Expected Progeny Differences (EPDs)

Expected Progeny Differences (EPDs) are the most powerful genetic tool we have for selecting the best animals for your breeding program. EPDs are values that predict how the future progeny of an animal will perform relative to the progeny of other animals in the same breed.

EPDs:

- allow breeders to estimate a young animal's breeding value - that animal's value as a parent
- allow a fair comparison of breeding value by removing environmental bias such as climate, feed and special management
- the best tool available to compare animals between herds, countries and year of birth
- help breeders make informed decisions regarding breeding stock selection by evaluating numerous traits such as

#1 Growth Related Traits (WW, YW, CW, Milk, RADG, DMI, F:G)

WEANING WEIGHT (WW) Expressed in pounds, is a predictor of a sire's ability to transmit weaning growth to his progeny compared to other sires.

YEARLING WEIGHT (YW) Expressed in pounds, is a predictor of a sire's ability to transmit yearling growth to his progeny compared to other sires.

MILK Expressed in pounds, is a predictor of the milking ability in a sire's daughters, representing the difference in weaning weights of calves due to the amount of milk produced by their mothers.

CARCASS WEIGHT (CW) is expressed in pounds predicting the differences in the average carcass weight of sires progeny.

RESIDUAL AVERAGE DAILY GAIN (RADG) Expressed in pounds per day, is a predictor of a sire's genetic ability for post weaning gain in future progeny compared to that of other sires, given a constant amount of feed consumed.

DAY MATTER INTAKE (DMI) Expressed in pounds per day, is a predictor of difference transmitting ability for feed intake during post weaning phase, compared to that of other sires.

FEED TO GAIN (F:G) Is the amount of feed (dry matter) consumed to gain one pound of gain, expressed as a ratio. The average feed conversion ratio is 6.1 to 1. Feed costs are 65- 70% of all costs.

#2 Reproductive Related Traits (BW, CE, MCE, SC, HPG, Stay)

BIRTH WEIGHT (BW) expressed in pounds, is a predictor of a sire's ability to transmit birth weight to his progeny compared to other sires.

CALVING EASE (CE) the average difference in ease with which a sire's calves will be born when he is bred to first calf heifers, a higher number indicates a higher probability that his calves will be born unassisted.

MATERNAL CALVING EASE (MCE) Predicting the average calving ease with which a sire's first calf heifers will calve when compared to daughters of other sires.

SCROTAL CIRCUMFERENCE (SC) Expressed in cm, is a predictor of the difference in transmitting ability for scrotal size compared to other sires.

HEIFER PREGNANCY (HPG) is a predictor of the percent probability in a bull's daughter's ability to conceive and calve as two year olds

STAYABILITY (Stay) is the percent probability of daughters staying in production to at least six year of age.

#3 Carcass Related Traits (Fat , REA, % IMF)

To evaluate seed stock, use EPDs, pedigree and visual assessment. With EPDs, the concept of "intermediate optimums" works best.

Selection for one trait or for extremes generally results in unexpected consequences due to genetic correlations - for example, intense selection for high yearling weight will generally increase birth weight. Successful cattle breeding requires a thoughtful and balanced approach to optimize fertility, growth and carcass merit while improved profitability and efficiency. With all the data that comes with each bull, I'm sure at times it must be overwhelming. In order to use body composition EPDs of ultrasound data to their full potential, a breeder must have an understanding of the ultrasound terminology. Several of the ultrasound measurements are comparable to the familiar carcass measurements. The data is simply collected on yearling bulls and heifers instead of market ready steers. Take a step back from looking at the numbers and become comfortable with the terminology.

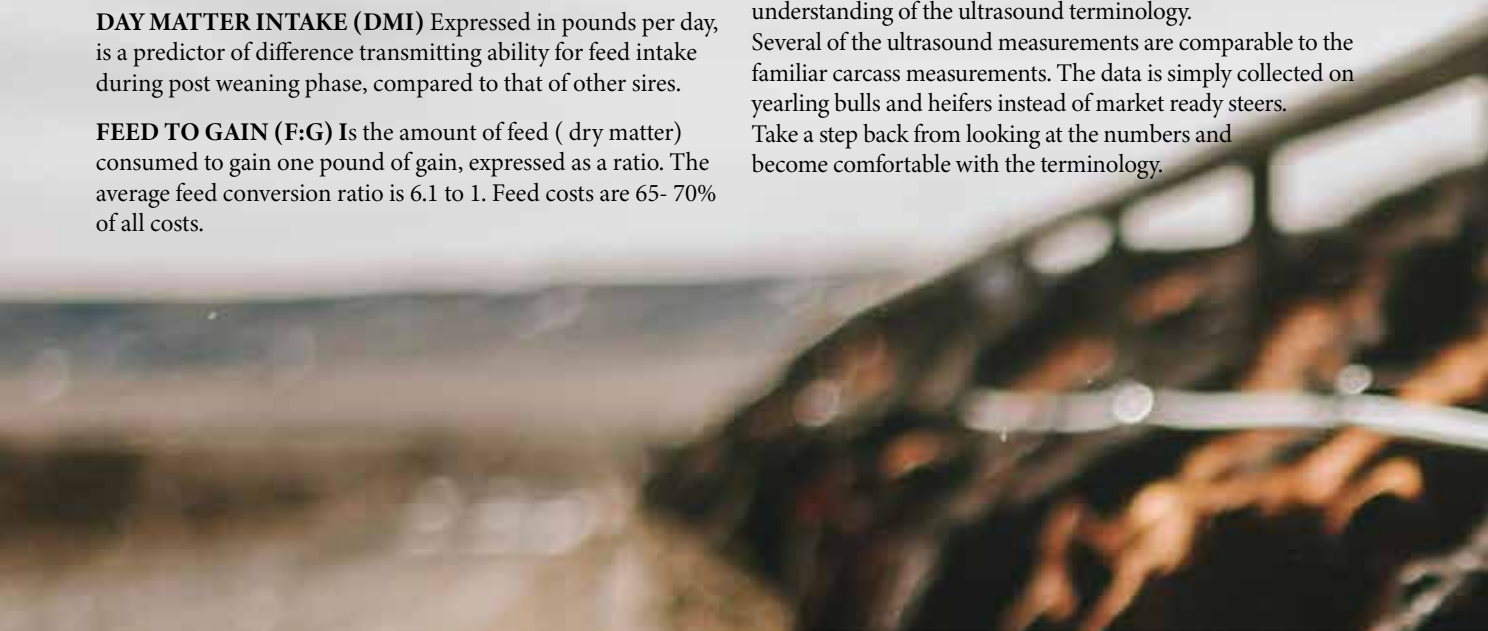

RIB FAT An external fat measurement taken between the 12th and 13th rib - the location a carcass would be split into quarters in the cooler reported in inches. Rib fat is the main factor in the USDA Yield Grade Equation.

RIBEYE AREA (REA) An area measurement of the longissimus dorsi, or ribeye muscle - reported in square inches. This image tends to be the most difficult to collect and requires the most highly skilled interpreting technician. Both the rib fat and ribeye area measurements are taken from the same image. The REA score is reported as sq. in. per 100lbs. of body weight.

RUMP FAT An external fat measurement taken from an image collected between the hooks and the pins of the animal, reported in inches. The rump fat measurement coupled with the rib fat measurement, is used to determine more accurately the overall external body fat, enhancing the accuracy of predicting percent retail product (PRP). In most cases, an animal will exhibit more fat over the rump than the rib due to physiological process of "laying on fat." Therefore, more variation is often displayed in the rump fat measurements of a contemporary group than the rib fat. This image is highly repeatable and is the least difficult to collect or interpret.

INTRAMUSCULAR FAT (%IMF) This measurement determines the amount of fat within the muscle (similar to marbling) and is reported in "%." This measurement should be collected when cattle are maintaining a high level of nutrition. The field technician collects four images and the values generated by the interpreting software are averaged for an overall %IMF.

The Angus Associations, both AAA and CAA have adopted the CUP (Centralized Ultrasound Processing) Program for Ultrasounding Carcass Data and are using this information for formulating Carcass EPDs. This is the 22nd year we have provided ultrasound measurements as taken by certified technicians. We feel it is very important that you, our valued customer, know what is under the hide as that really does determine value. It has been determined through many studies that carcass traits are highly heritable and that feeding has only marginal effect on the resulting carcass - genetics determine carcass quality!

OCTOBER 2022 ANGUS EPD AVERAGES FOR ALL CALVES BORN IN 2021

BLACK ANGUS

CE	BW	WW	YW	Milk	CW	REA	Marb	Fat	CBI
+3.4	+2.1	+51	+89	+23	+38	+0.48	+0.41	+0.015	+273

RED ANGUS

CE	BW	WW	YW	Milk	CW	REA	Marb	Fat	CBI
+2.6	+1.1	+39	+66	+24	+23	+0.37	+0.23	+0.00	+216

THE BEEF BUSINESS



“ The following results is what this beef business is all about, producing a product that is in special, special demand, being top quality **PRIME Graded Beef.** ”

The last three loads of finished cattle harvested at a Federally Inspected Plant provided the astonishing results. The three loads of cattle came from three different yards so not fed necessarily the same.

It is the GENETICS !!!

1 First Load of 43 Steers Sired by **Benchmark® Bulls**
88.4% PRIME,
11.6 % AAA
with only 1 YG4 and NoYG5's

2 Second Load of 39 Virgin Bulls Sired by **Benchmark® Bulls**
66.7 % PRIME
33.3 % AAA
with only 1 YG4 and no YG5's

3 Third Load of 39 Virgin Bulls Sired by **Benchmark® Bulls**
84.6 % PRIME , 15.4 % AAA
with no YG4's nor 5's,
10 YG 3's and 29 YG 1's and 2's

“ **OUTSTANDING** ”



We hear a lot about increased costs and low margins or losses in the cattle industry. We can do better , much better and become more profitable , much more profitable.

Be sure your cattle measure up “ **USE A BENCHMARK® BULL**”
And become part of the **BENCHMARK® Program**
www.benchmarkangus.com

NOTES



SALES TERMS & CONDITIONS

TERMS:

The terms of the sale are cash or cheque payable at par to Benchmark Farms Ltd., Lethbridge, AB unless prior arrangements are made with the seller. The right of property shall not pass until full settlement is made. All arrangements and settlements must be made with Benchmark Farms Ltd. before any cattle will be release.

PURCHASER'S RISK:

Each animal becomes the risk of the purchaser as soon as sold.

CERTIFICATE OF REGISTRY:

A certificate of registry duly transferred will be furnished to the buyer for each animal after settlement is made.

BIDS AND BIDDING:

Sale bidding opens: November 28th at 12pm MST.
Sale bidding soft closes: November 30th at 7pm MST.
During the Racehorse Style soft close extended bidding always follow the clock of remaining time left to bid.

SHIPPING:

Assistance will be given in making shipment after the sale but no risk is assumed by the seller. Expenses incurred are the responsibility of the purchaser. Purchasers are requested to furnish shipping instructions when making settlement. Any additional expenses are the responsibility of the buyer, including duty, brokerage fees, etc.

ACCIDENTS:

Although every precaution will be taken too ensure the safety of visitors to the ranch, the owners do not assume any responsibility or liability, legal or otherwise, in the event of any unforeseen incidents resulting damage or loss of property.

BREEDER'S GUARANTEE:

Everything possible has been done to assure that every bull in this sale will be a breeder. Taber Cattle Clinic semen tested and physically evaluated every bull. However, should a problem arise, please inform the seller so further arrangements may be made.

Semen Interest Retained Benchmark® Angus retains a one-third semen interest in every bull selling.



BENCHMARK[®]
Your Carcass Source *Angus*



**BENCHMARK FARMS LTD.
BOX 997, LETHBRIDGE, AB T1J 4A2**